



**Information Technology Services**

3300 Capitol Avenue, Building B, Fremont, CA 94538

510-494-4821 fax | [www.fremont.gov](http://www.fremont.gov)

Date: November 12, 2024

To: Victor Chin  
61 Madera Ave Unit A  
San Carlos, CA 94070  
AND  
Kenneth Chin  
36466 Laredo Dr  
Fremont, CA 94536

Requestor: VTZAN  
Discretionary Rev: PLN2024-00135  
Permitting File#: BLD2025-02619  
SP#: 54-0057  
APN#: 501 004211900  
**Zip Code: 94536**  
Fire ESZ | Box/S-Dist: 08 - 445 | 6-8 / 88A1  
**Address For:** Residence

Re: Addresses for Residential Parcel (Lot 2 of Parcel Map 10696)

- 36478 Laredo Dr (*Property/Situs and single-family dwelling*)
- 36482 Laredo Dr (*junior accessory dwelling unit*)
- 36490 Laredo Dr (*single-family dwelling*)
- 36492 Laredo Dr (*accessory dwelling unit*)

To Whom It May Concern:

In response to your request for addresses needed for a residential parcel, a total of four (4) new addresses have been assigned. For a full inventory and description of the addresses, please refer to Table “A”. The enclosed Addressing Plan illustrates the proper use and placement of the new address.

**Electronic copies of this letter and documentation will be posted to the City’s web site at <https://city.fremont.gov/addressingprojects> within 10 business days. The files will be stored under SP54-0057.**

**Documents available on Web Site:**



X	Notification Letter
X	Address Plan (map)
	AutoCAD Drawing

	Address Table
	G.I.S. Layer

In accordance with Title 15 (Buildings and Construction) Chapter 15.55 (House Numbering) of the Fremont Municipal Code, this letter serves as the notice of the addressing action affecting your property. The new address must be in use within ten (10) days of the receipt of this letter. For information on the size and location of address numbers on a building, please refer to the enclosed information sheet titled “ADDRESSING – Property Owner Responsibilities” and to Chapter 15.50 (Building Security) of the Title 15 (Buildings and Construction).

Victor Chin and Kenneth Chin  
November 12, 2024

Page 2 of 3

You will need to update your address records and outside address numbers as soon as possible for the purpose of rapid identification of your property in the event of an emergency. Any occupants and property owner of this parcel should review and update their records that are registered with the City (such as for building permit and/or business tax purposes). And, by copy of this letter, we are notifying the below-listed agencies and utility companies. However, be aware that some agencies may not update their records until notified by the property owner. Therefore, it is your responsibility to make sure that the appropriate agencies or businesses acknowledge the correct addresses.

**If you have any questions concerning this matter, please contact Ron Chan at (phone) 510-494-4832 or (e-mail) rchan@fremont.gov.**

Sincerely,

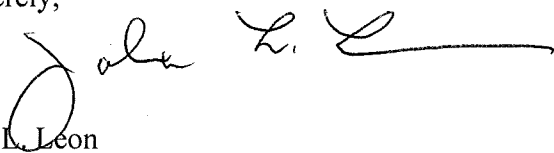

John L. Leon  
GIS and Addressing Manager

Enclosures (hardcopy/paper): Address Plan - map (1) and Property Owner Responsibilities Information Sheet.

cc: **Sent via e-mail:**

Alameda County Assessor's Office  
Alameda County Registrar of Voters  
Alameda County Regional Emergency Communication Center - Dublin  
Alameda County Water District  
Alameda County 911 (Coordinator)  
Alameda County Main Post Office (Address Mgmt. Systems Manager)  
AT&T – Database Center / SLIC  
Cooperative Strategies/Dolinka Group  
Fremont Unified School District (Facilities Director)  
Fremont Main Post Office (Station Manager) – zip code area 94536 / 94537 / 94555  
Republic Services  
US Postal Service / AMS  
Lynx Technologies  
Pacific Gas & Electric (Service Planning Dept.)  
AT&T – Engineering  
Union Sanitary District  
Fremont Community Development – Building & Safety  
Fremont Community Development – Fire & Life Safety  
Fremont Community Development – Planning  
Fremont Community Services – Environmental Services  
Fremont Plans & Permits

## LOCATIONAL MAP

(For reference only – see official addressing map for actual/correct address)

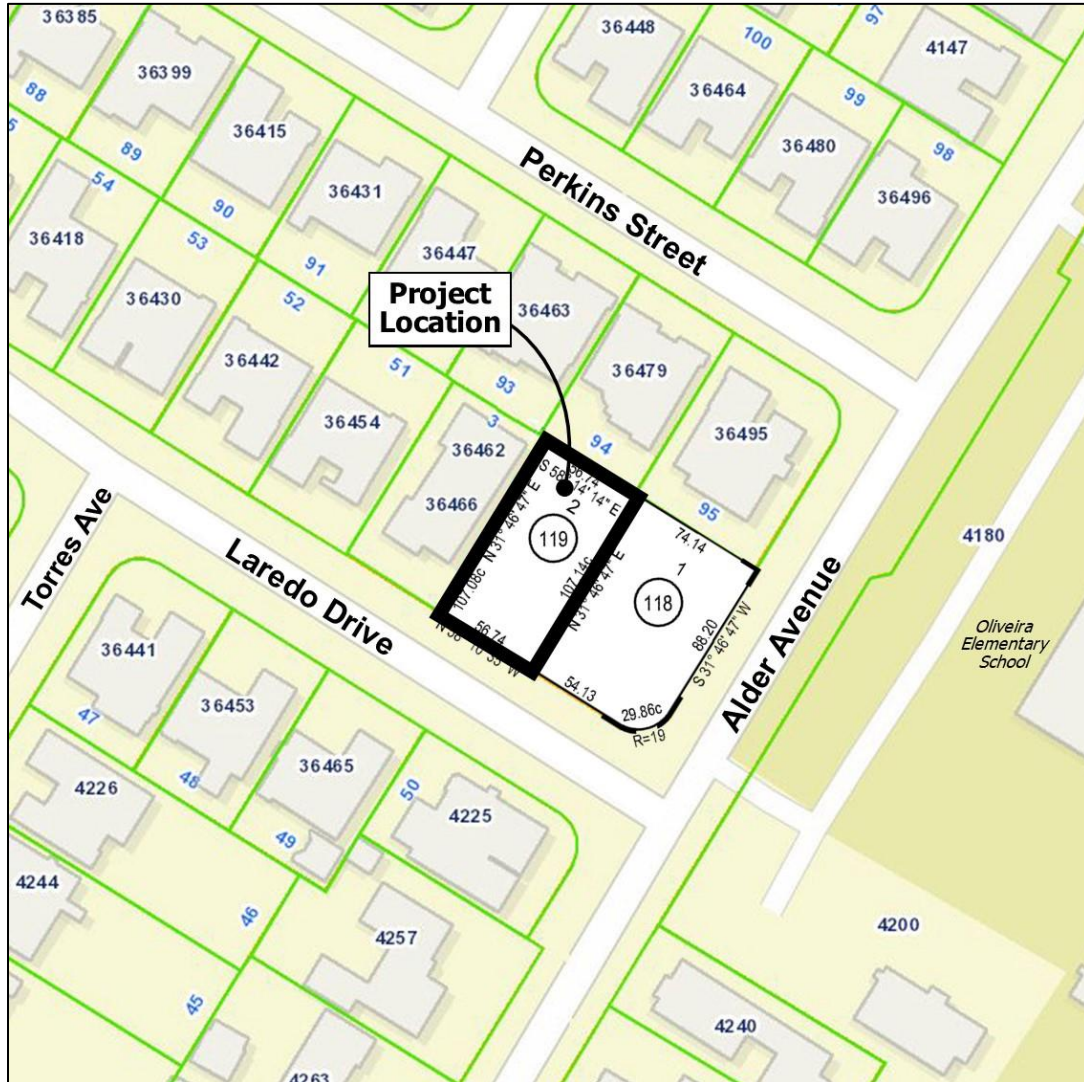

**TABLE A:** Authorized Addresses

Record	Address No.	Street Name	Unit No.	Zip Code	Bldg	Floor	Subdivision No.	Land Lot	Condo Lot	Address Type	Address Status
1	36478	Laredo Dr		94536	Bldg C		PM 10696	Lot 2		Property/Situs	Assigned
2	36482	Laredo Dr		94536	Bldg C		PM 10696	Lot 2		Jr. Accessory Dwelling Unit	Assigned
3	36490	Laredo Dr		94536	Bldg D		PM 10696	Lot 2		Single-Family Dwelling	Assigned
4	36492	Laredo Dr		94536	Bldg D		PM 10696	Lot 2		Accessory Dwelling Unit	Assigned