



Date: October 21, 2015

To: Brian Hardy
 VD Fremont 36, LLC
 2430 Camino Ramon, Ste 125
 San Ramon, CA 94583
 AND
 Gordon Zanin
 Carlson, Barbee & Gibson
 2633 Camino Ramon, Ste 350
 San Ramon, CA 94583

Requestor: KREY
 Discretionary Rev: PLN2015-00264; SAM2015-00013
 Permitting File#: various
 SP#: 54-0060
 APN#: 501 004207600
Zip Code: 94536
 Fire ESZ | Box/S-Dist: 08 – 445 | 6-8 / 88A1
Address For: Residential subdivision

Re: Addresses for Tract 8192 –
 • New: Calabria Cmn, Tauro Ter and Valentia Ter
 • Rescinded: 4325 and 4339 Alder Ave

To Whom It May Concern:

In response to your request for addresses needed for a new residential subdivision, a total of eighteen (18) new addresses have been assigned. And, as part of this addressing action, two existing addresses (i.e., 4325 and 4339 Alder Ave) have been rescinded because they are no longer required.

For a full inventory and description of the addresses, please refer to Table “A”. The enclosed Addressing Plan illustrates the proper use and placement of the new addresses.

Electronic copies of this letter and documentation will be posted to the City’s web site at http://gis.ci.fremont.ca.us/addr/addr_proj.cfm within 10 business days. The files will be stored under SP54-0060.

Documents available on Web Site:

X	Notification Letter		Address Table
X	Address Plan (map)		G.I.S. Layer
	AutoCAD Drawing		

In accordance with Title 15 (Buildings and Construction) Chapter 15.55 (House Numbering) of the Fremont Municipal Code, this letter serves as the notice of the addressing action affecting your property. The new address must be in use within ten (10) days of the receipt of this letter. For information on the size and location of address numbers on a building, please refer to the enclosed information sheet titled “ADDRESSING – Property Owner Responsibilities” and to Chapter 15.50 (Building Security) of the Title 15 (Buildings and Construction).

You will need to update your address records and outside address numbers as soon as possible for the purpose of rapid identification of your property in the event of an emergency. Any occupants and property owner of this parcel should review and update their records that are registered with the City (such as for building permit and/or business tax purposes). And, by copy of this letter, we are notifying the below-listed agencies and utility companies. However, be aware that some agencies may not update their records until notified by the property owner. Therefore, it is your responsibility to make sure that the appropriate agencies or businesses acknowledge the correct addresses.

If you have any questions concerning this matter, please contact Ruby Wun at (phone) 510-494-4833 or (e-mail) rwun@fremont.gov.

Sincerely,

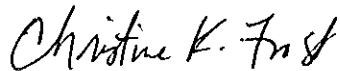

Christine K. Frost
GIS and Addressing Manager

Enclosures (hardcopy/paper): Address Plan - map (1) and Property Owner Responsibilities Information Sheet.

cc: **Paper copy mailed to:**
Alameda County Assessor's Office
Alameda County Regional Emergency Communication Center - Livermore
Alameda County Regional Emergency Communication Center - Dublin (Joshua Harris)
Alameda County Registrar of Voters
Alameda County Water District (2)
Alameda County 911 (Coordinator)
Alameda County Main Post Office (Donna Canalin)
Republic Services (Customer Service Manager)
Fremont Main Post Office (David Epps) – zip code area 94536 / 94537 / 94555
US Postal Service / AMS – PIQA (Debbie Horton)
US Postal Service / AMS (Veronica Chavez)
Fremont Unified School District (Facilities Director)
Schoolworks (Kathy Reynolds)
Lynx Technologies
Pacific Gas & Electric (Jessica Jones / Service Planning Dept.) (2)
AT&T – Engineering
Union Sanitary District (2)

Sent via e-mail:

Alameda County Assessor's Office
AT&T – Database Center / SLIC
Fremont Community Development - Site Plan Architectural Review (BPSPAR)

Fremont Community Development – Fire & Life Safety (Howard Hancock)
Fremont Plans & Permits
Fremont Environmental Services (Lori Marra)
Fremont GIS (Ruby Wun; file copy - letter only)

LOCATIONAL MAP
(For reference only – see official addressing map for actual/correct address)

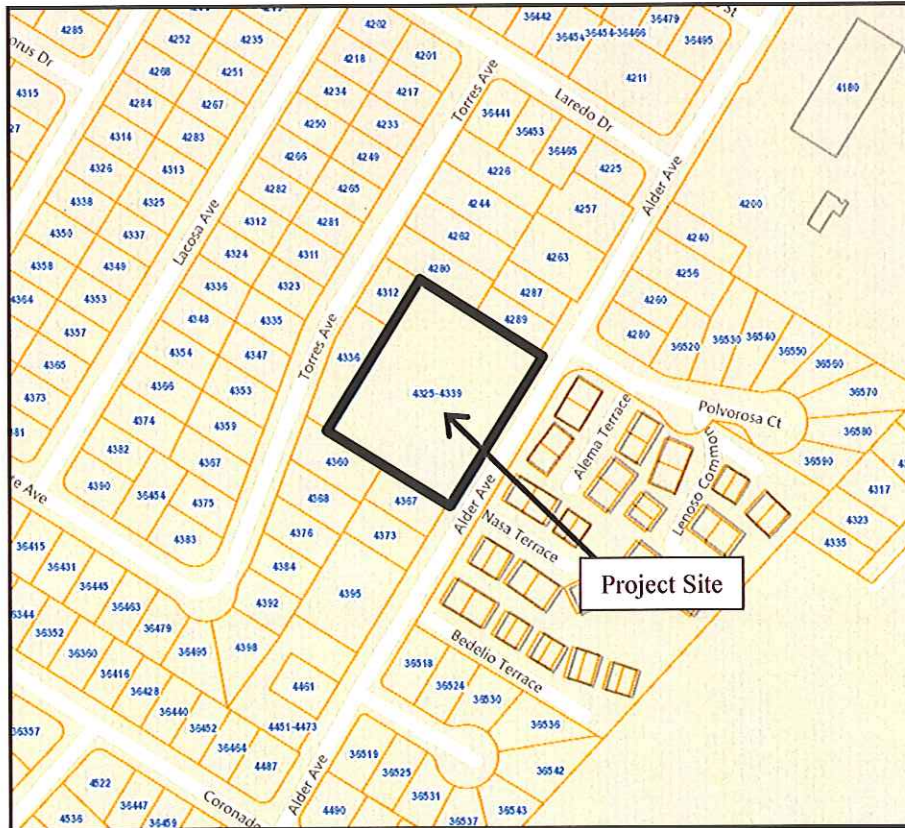

TABLE A:

Record	Address No.	Street Name	Zip Code	Subdivision No.	Lot No	Address Type	Address Status
1	36408	Calabria Cmn	94536	TR 8192	Lot # 1	Single Family RES SF	New
2	36411	Calabria Cmn	94536	TR 8192	Lot A (Calabria Cmn r.o.w)	Electrical Meter MISC UTIL	New
3	36414	Calabria Cmn	94536	TR 8192	Lot # 2	Single Family RES SF	New
4	36420	Calabria Cmn	94536	TR 8192	Lot # 3	Single Family RES SF	New
5	36449	Calabria Cmn	94536	TR 8192	Lot # 15	Single Family RES SF	New
6	36455	Calabria Cmn	94536	TR 8192	Lot # 16	Single Family RES SF	New
7	36478	Calabria Cmn	94536	TR 8192	Lot # 12	Single Family RES SF	New
8	36484	Calabria Cmn	94536	TR 8192	Lot # 13	Single Family RES SF	New
9	36490	Calabria Cmn	94536	TR 8192	Lot # 14	Single Family RES SF	New
10	36491	Calabria Cmn	94536	TR 8192	Lot # 17	Single Family RES SF	New
11	4331	Tauro Ter	94536	TR 8192	Lot # 5	Single Family RES SF	New
12	4332	Tauro Ter	94536	TR 8192	Lot # 6	Single Family RES SF	New
13	4337	Tauro Ter	94536	TR 8192	Lot # 4	Single Family RES SF	New
14	4338	Tauro Ter	94536	TR 8192	Lot # 7	Single Family RES SF	New
15	4340	Valentia Ter	94536	TR 8192	Lot # 10	Single Family RES SF	New
16	4343	Valentia Ter	94536	TR 8192	Lot # 9	Single Family RES SF	New
17	4346	Valentia Ter	94536	TR 8192	Lot # 11	Single Family RES SF	New
18	4349	Valentia Ter	94536	TR 8192	Lot # 8	Single Family RES SF	New
19	4325	Alder Ave	94536			Original parcel address	Rescinded
20	4339	Alder Ave	94536			Original parcel address	Rescinded