

**ADDRESS CHRONOLOGY**

- Initial addressing at time of original development: 3/6/1987 (JC)
- Verification/re-activation of existing address and address assignment to two meters for new tenant space: 12/2/2015 (RW)

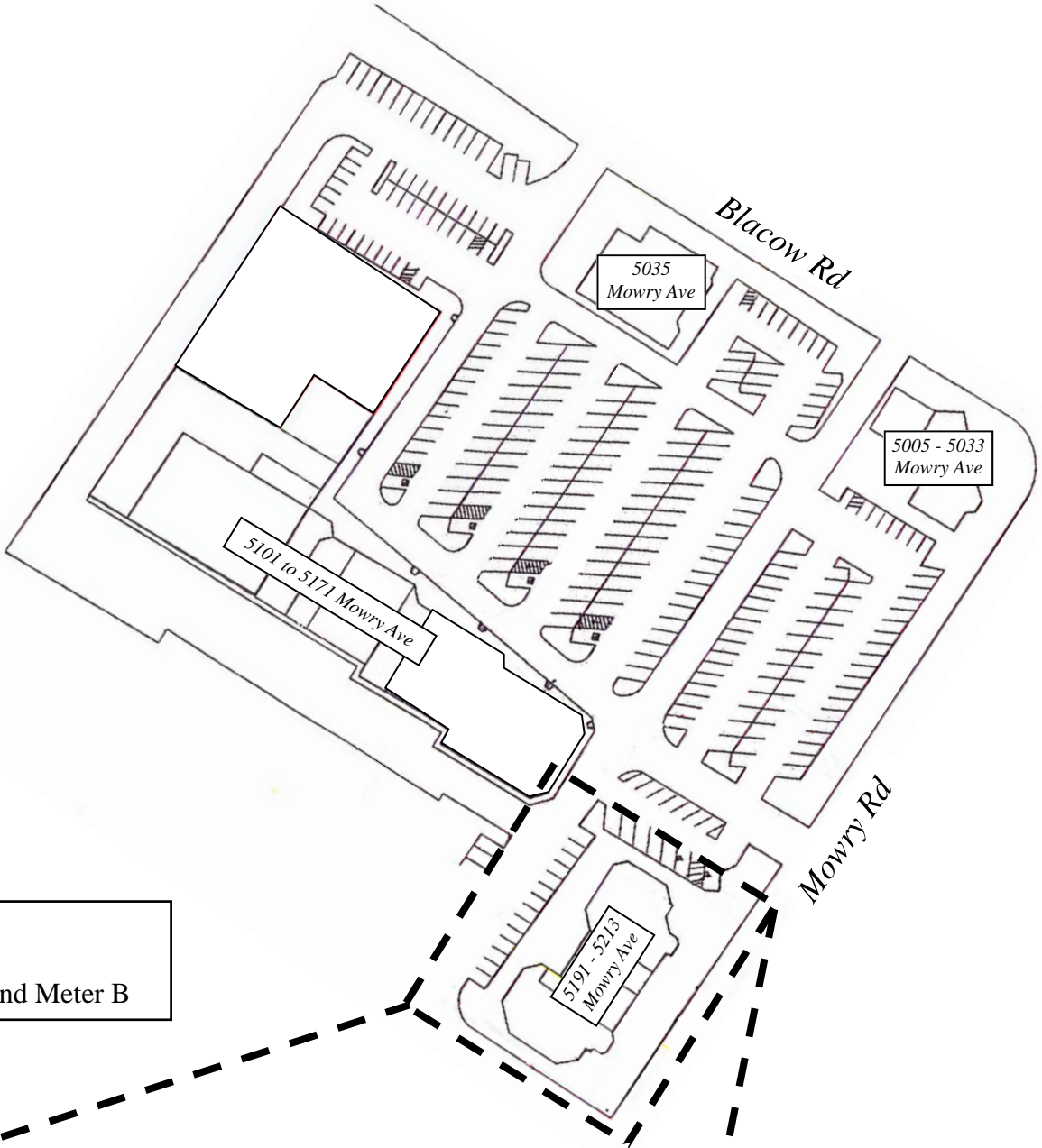

**Verified - tenant space address: 5213 Mowry Ave**  
**New - meter addresses: 5213 Mowry Ave Meter A and Meter B**

