

LOCATIONAL MAP

ADDRESS CHRONOLOGY

- Initial addressing at time of original development: 5/28/1993 (ME)
- Additional address issued: 10/4/1999 (MS)
- Addressing of new PG&E meter and verification of existing address (i.e., 37260 Fremont Blvd) as the situs/property address: 10/25/2019 (RW)

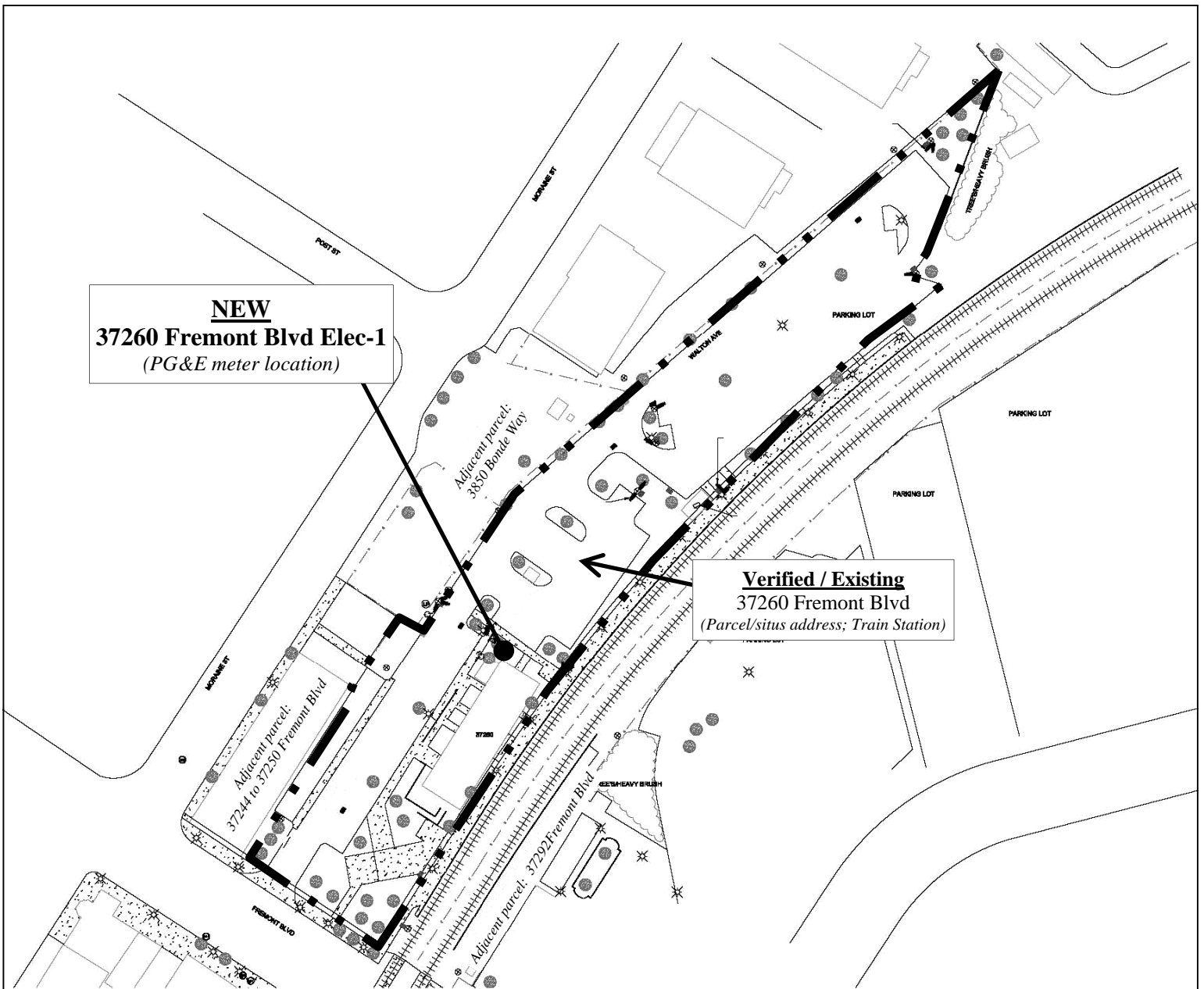

FOR ADDRESSING PURPOSES ONLY

SP60-0093 10/25/2019 (RW)