

NOTE: See pages 2 through 5 for unit and tenant space addresses.

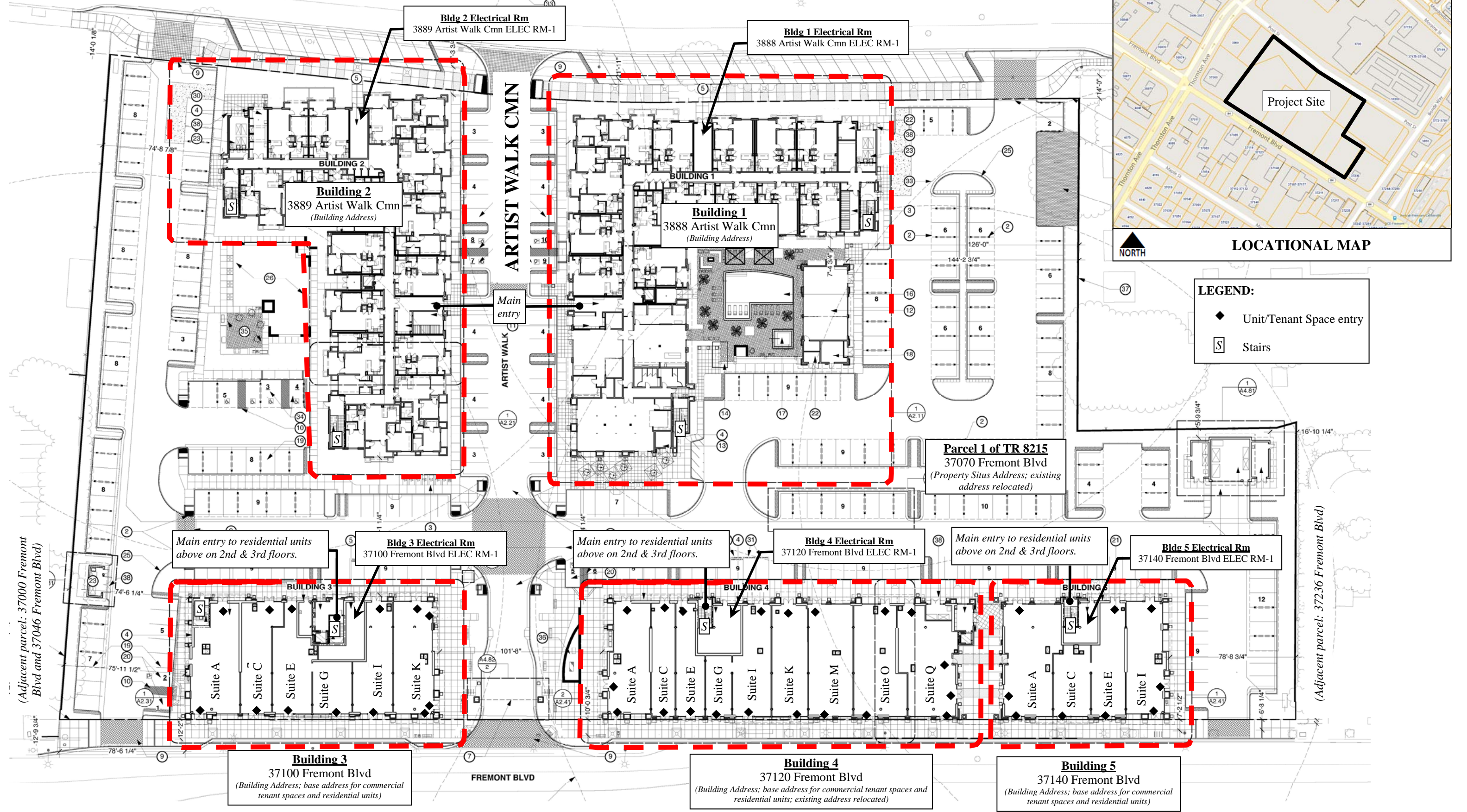

FOR ADDRESSING PURPOSES ONLY - TR 8215
SP60-0134 11/3/2015 (RW) Page 1 of 5

ADDRESS CHRONOLOGY
• Initial addressing for original development: 10/11/1985; 10/28/1986; 3/23/1990; 12/1/1995; 1/18/1999
• Addresses issued for TR 8215 and rescinded existing addresses no longer required for project site: 11/3/2015 (RW)

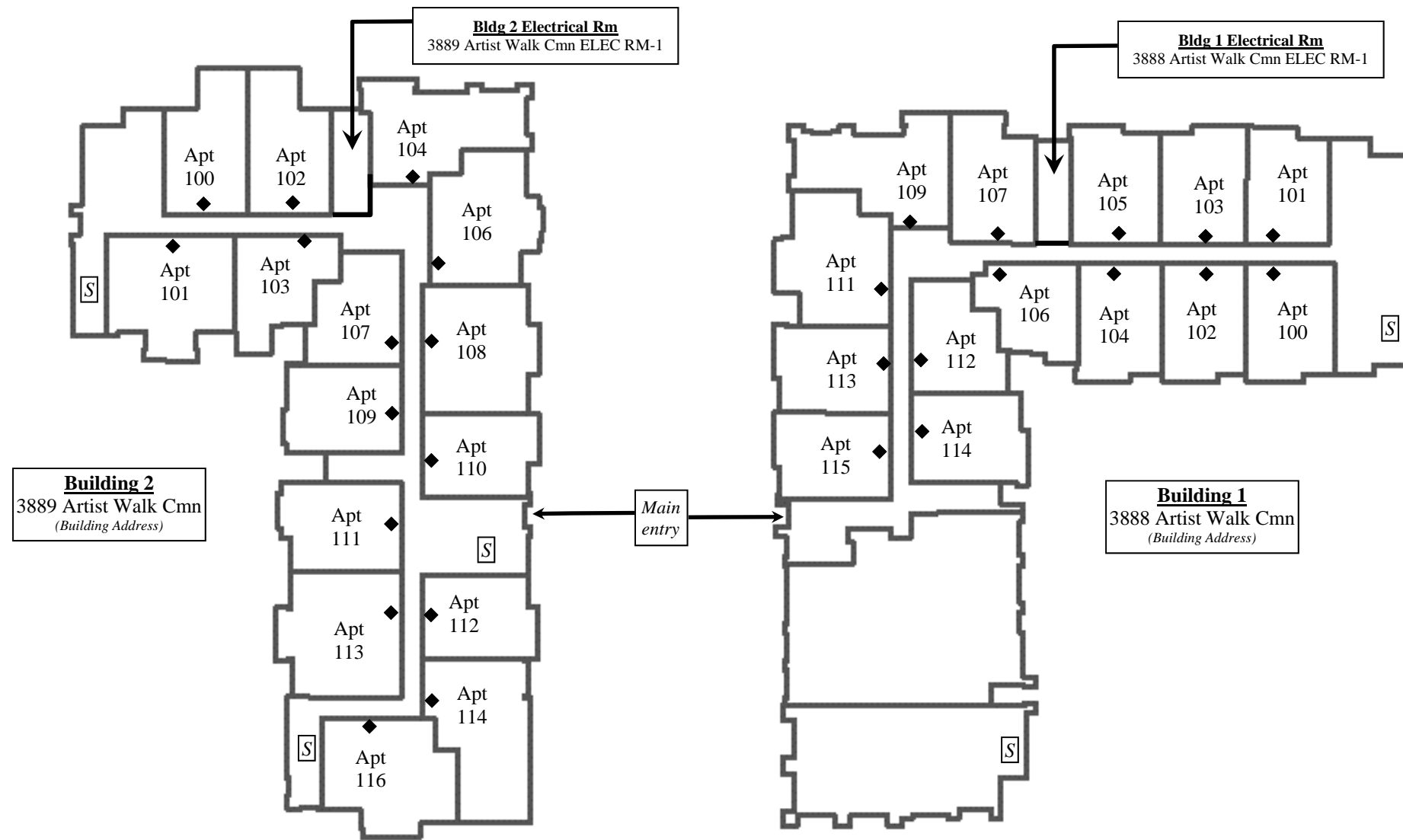

LEGEND:

- ◆ Unit/Tenant Space entry
- Ⓢ Stairs

Showing First Floor level of all buildings

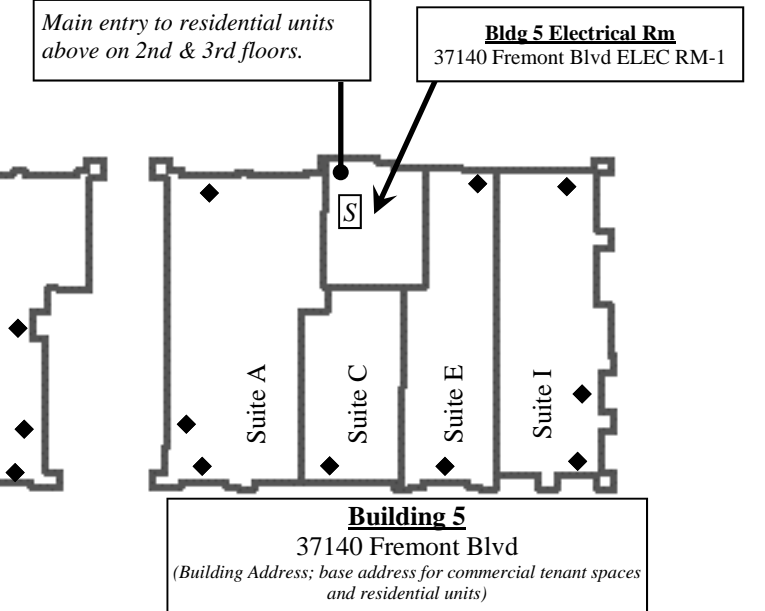
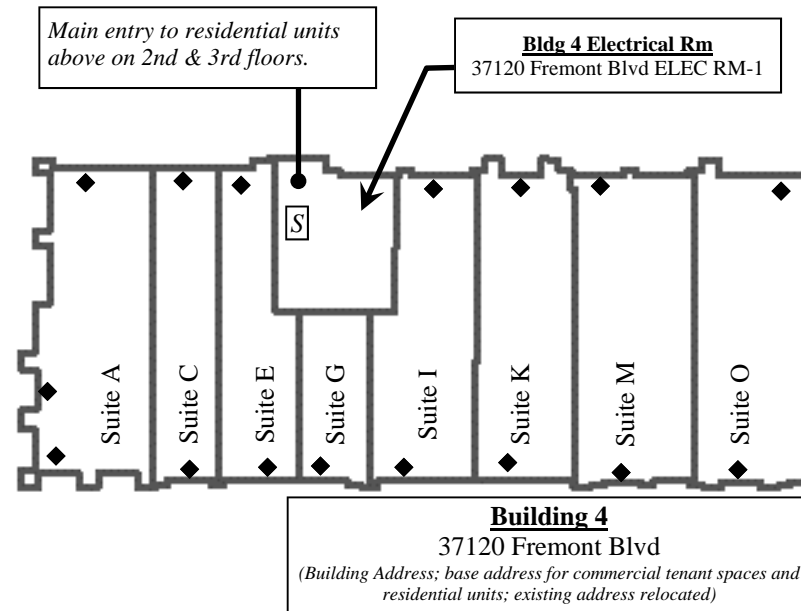
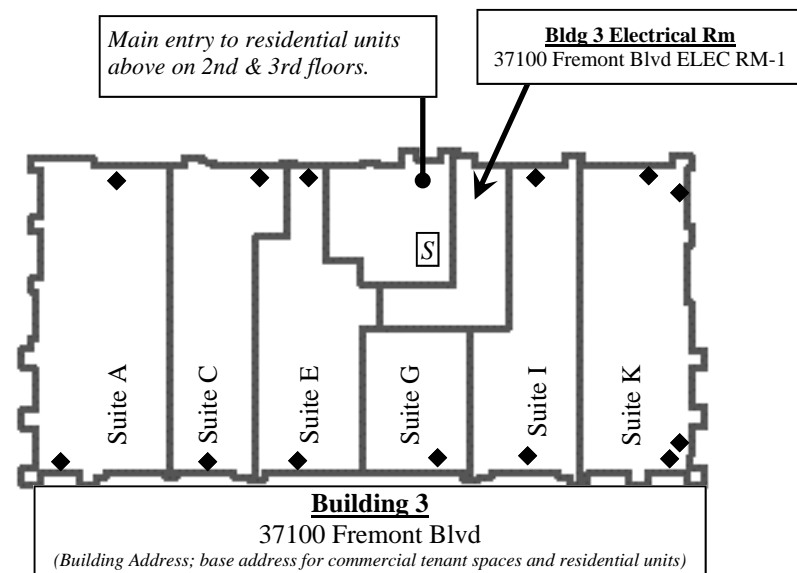

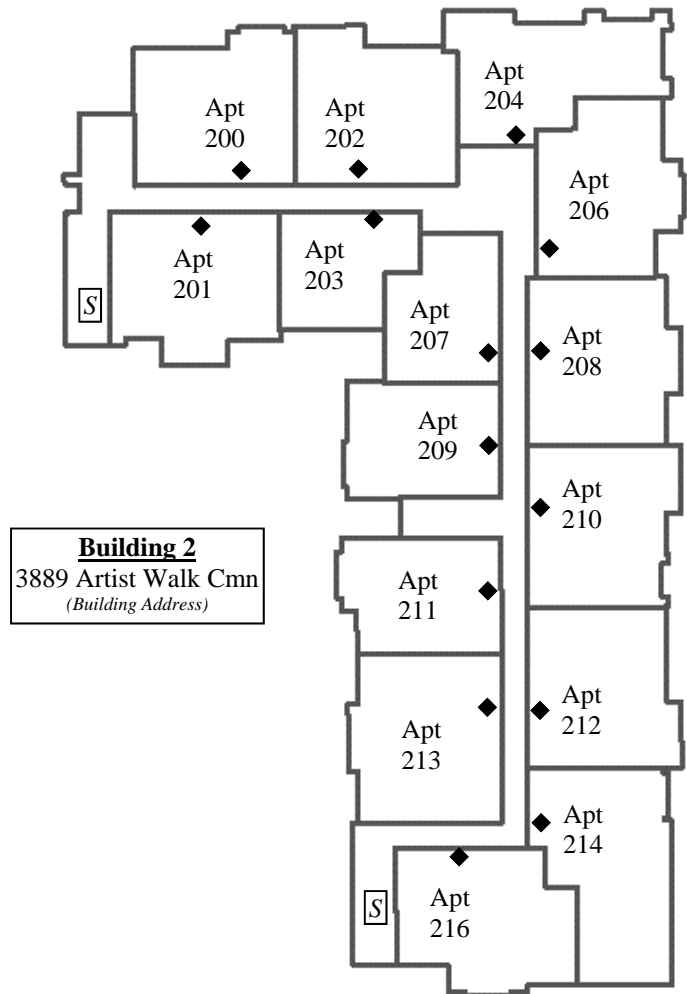

Building 2
3889 Artist Walk Cmn
(Building Address)

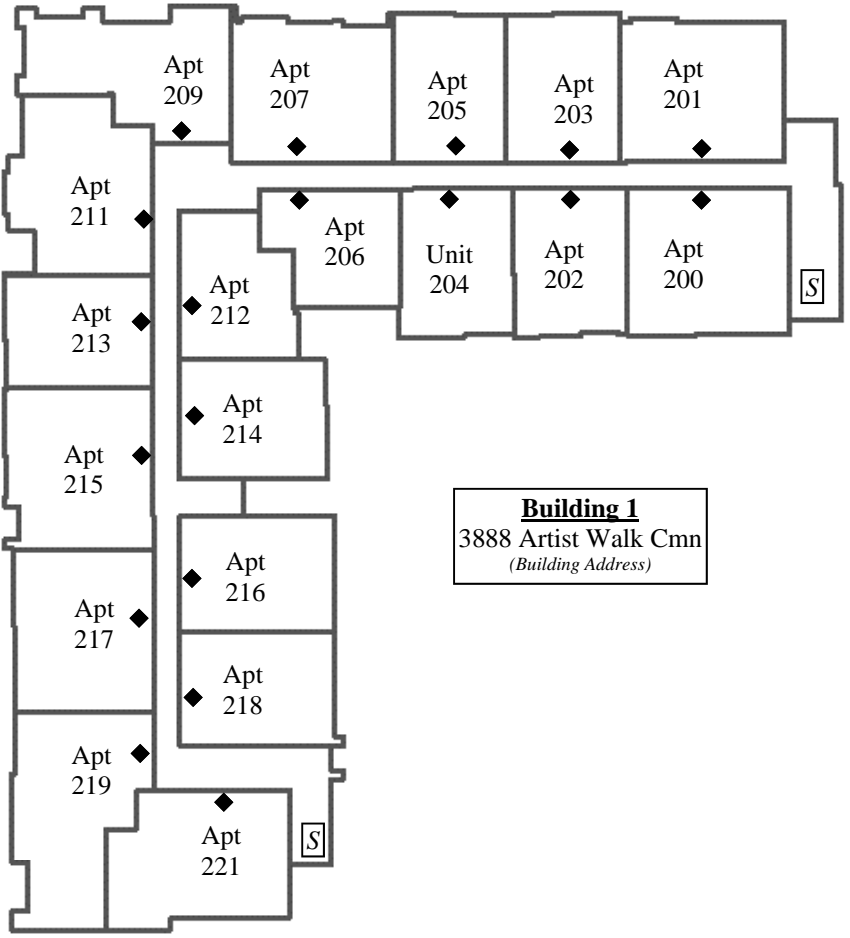

Building 1
3888 Artist Walk Cmn
(Building Address)

LEGEND:

- ◆ Unit/Tenant Space entry
- Ⓢ Stairs

Showing Second Floor
level of all buildings

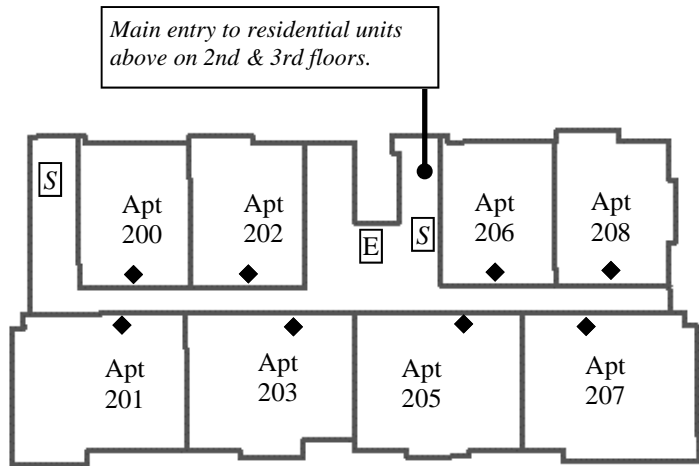

Building 3
37100 Fremont Blvd
(Building Address; base address for commercial tenant spaces and residential units)

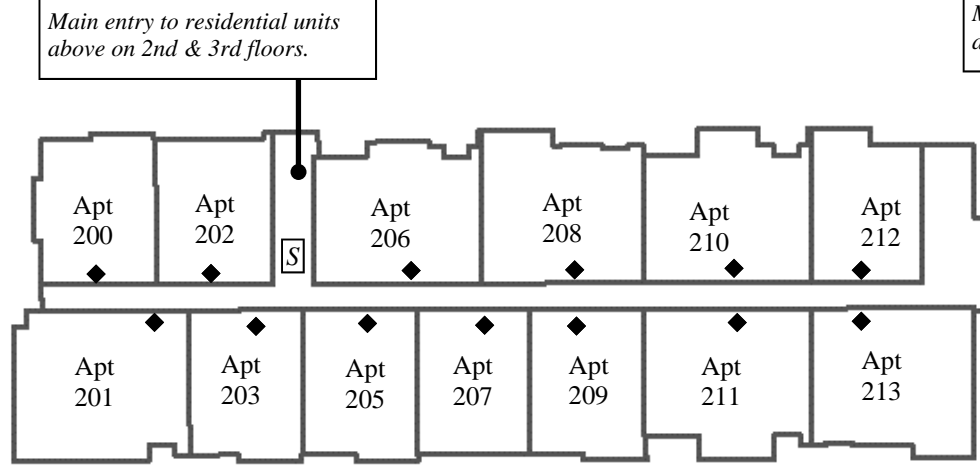

Building 4
37120 Fremont Blvd
(Building Address; base address for commercial tenant spaces and residential units; existing address relocated)

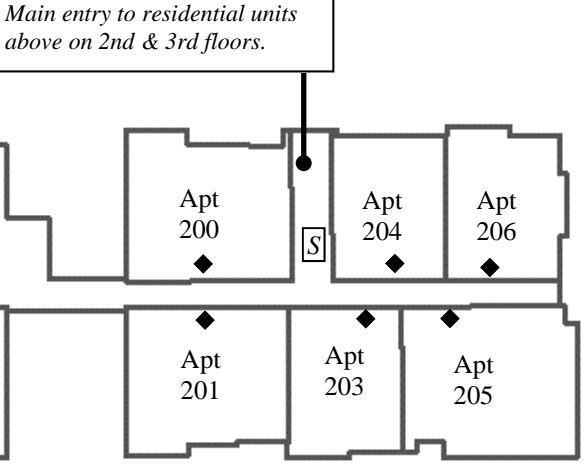

Building 5
37140 Fremont Blvd
(Building Address; base address for commercial tenant spaces and residential units)



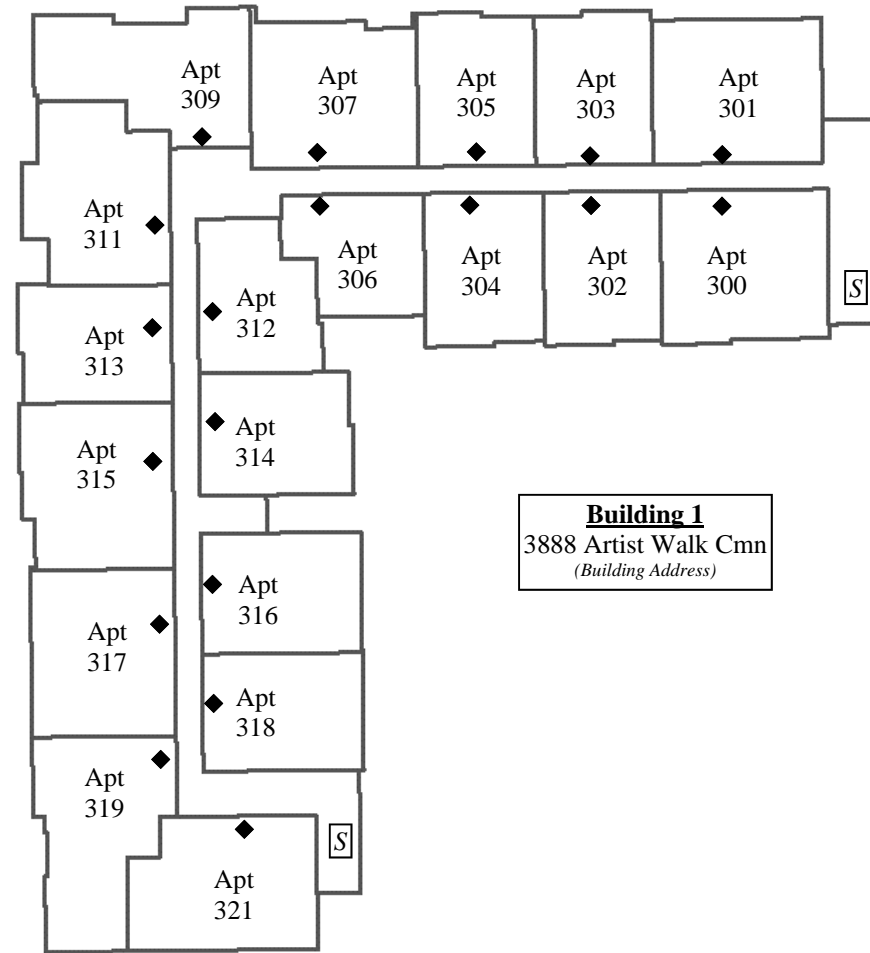
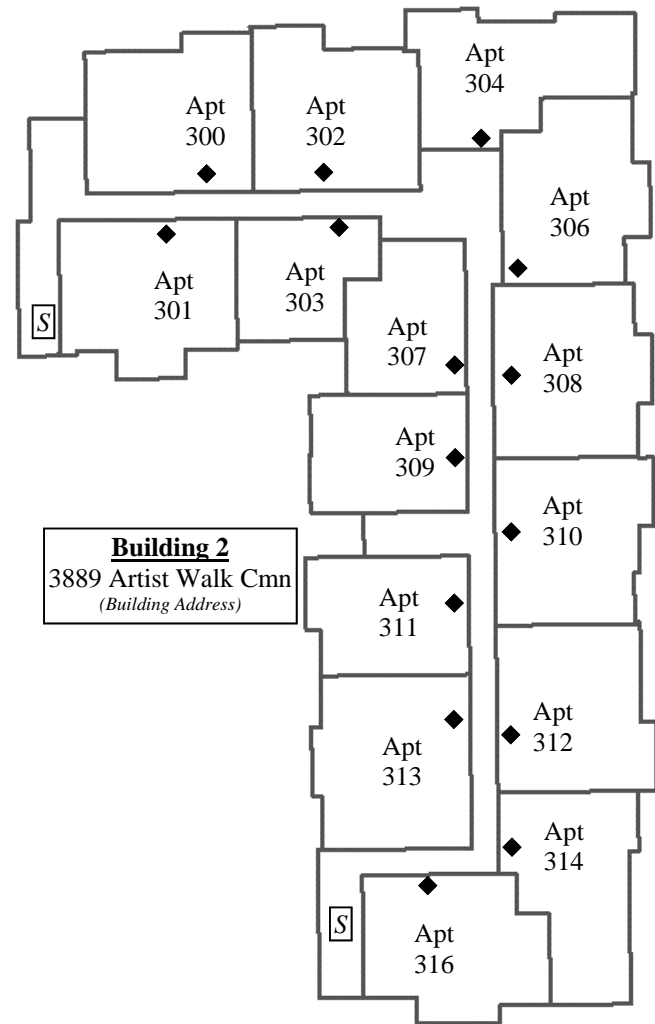

LEGEND:

- ◆ Unit/Tenant Space entry
- Ⓢ Stairs

Showing Third Floor level of all buildings

Building 3
37100 Fremont Blvd
(Building Address; base address for commercial tenant spaces and residential units)

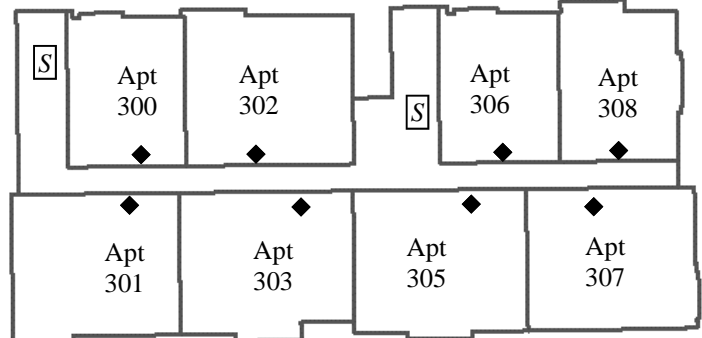

Building 4
37120 Fremont Blvd
(Building Address; base address for commercial tenant spaces and residential units; existing address relocated)

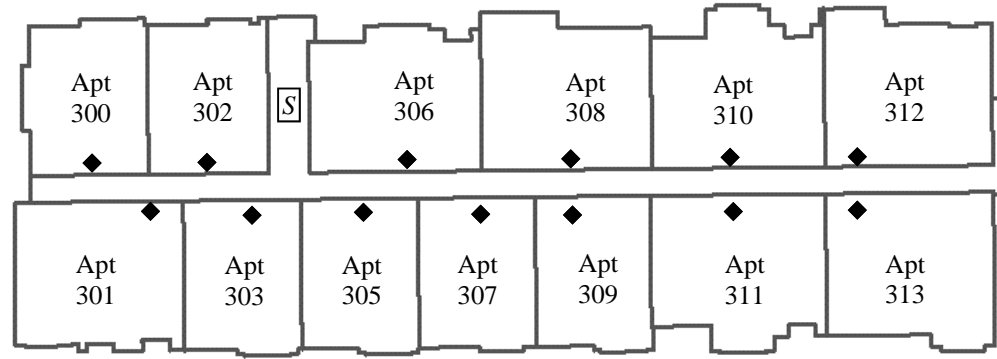

Building 5
37140 Fremont Blvd
(Building Address; base address for commercial tenant spaces and residential units)

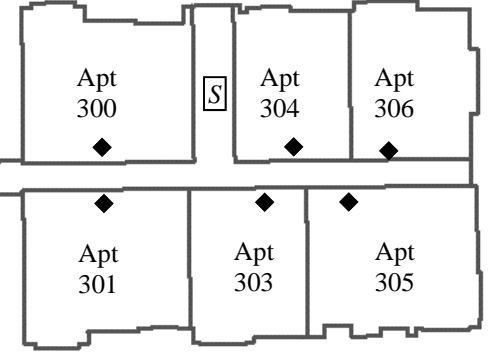

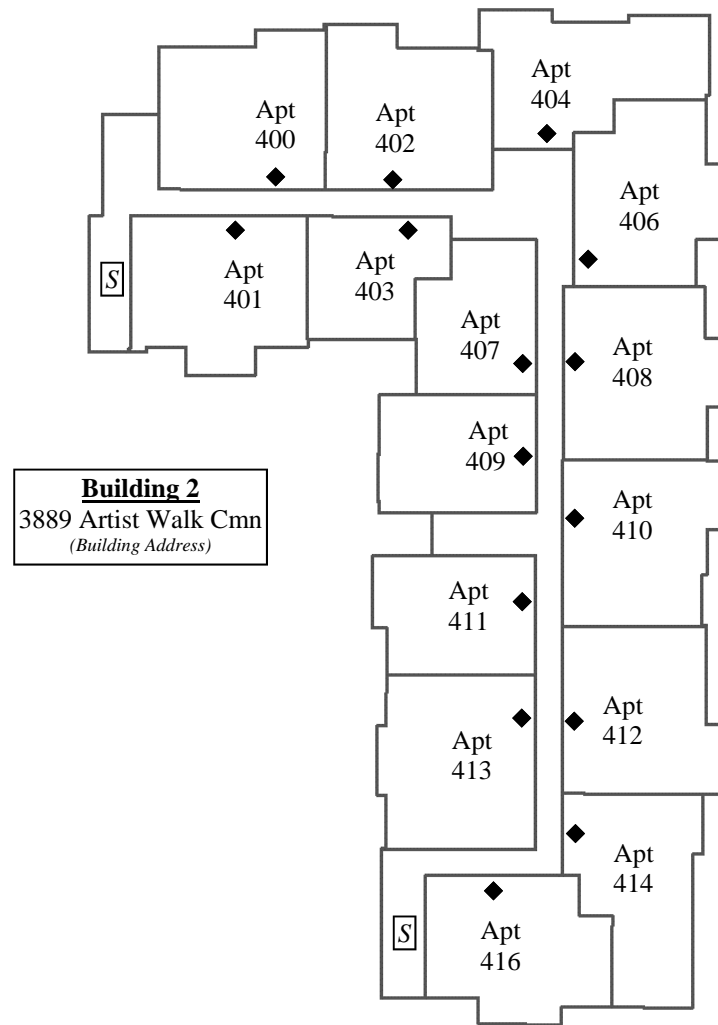

Building 2
3889 Artist Walk Cmn
(Building Address)

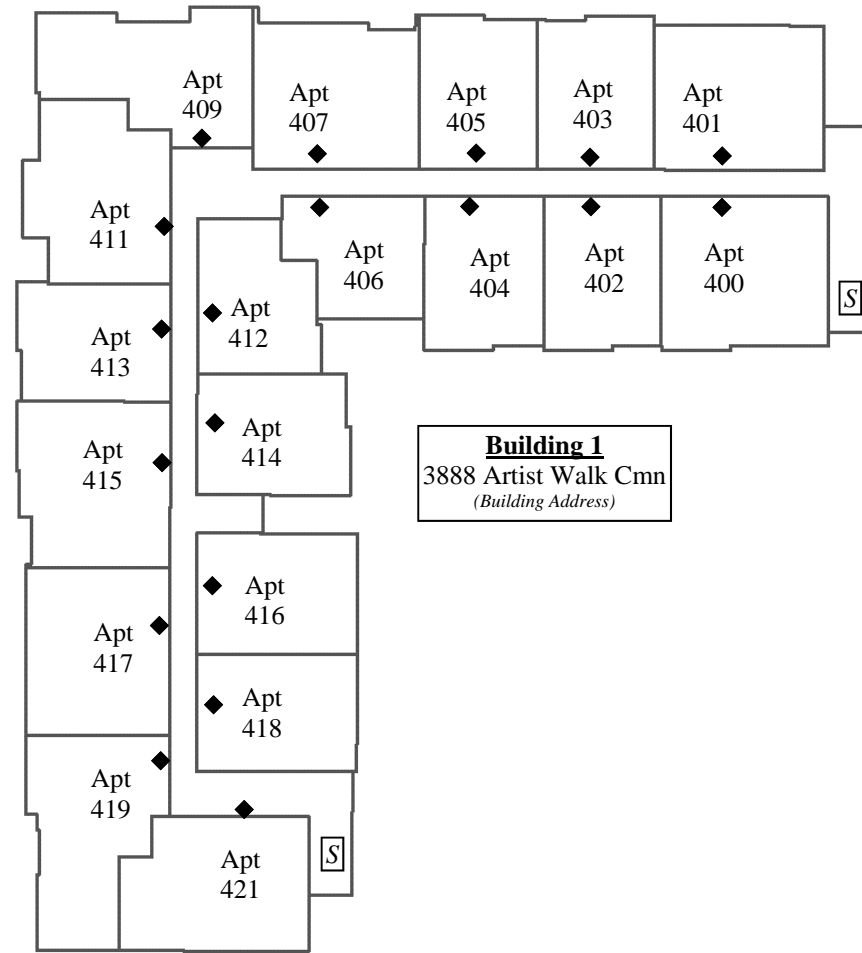

Building 1
3888 Artist Walk Cmn
(Building Address)

LEGEND:

- ◆ Unit/Tenant Space entry
- Ⓢ Stairs

Showing Fourth Floor level
of Buildings 1 and 2