



Information Technology Services  
 3300 Capitol Avenue, Building B, Fremont, CA 94538  
 510-494-4821 fax | www.fremont.gov

Date: March 26, 2015

To: David Agee  
 Warmington Residential  
 2400 Camino Ramon #234  
 San Ramon, CA 94583  
 AND  
 Doug Cummins  
 Dahlin Group  
 5865 Owens Dr  
 Pleasanton, CA 94588

Requestor: TWON / HLUU  
 Discretionary Rev: PLN2015-00098  
 Permitting File#: BLD2015-02417  
 SP#: 60-0157  
 APN#: 501 052101306; 501 052101316  
**Zip Code: 94536**  
 Fire ESZ | Box/S-Dist: 06 – 447 | 6-1 / 88A4  
**Address For:** Residence

Re: Addresses for new residential subdivision – TR 8182 (Talamore)

To Whom It May Concern:

In response to your request for addresses needed for a new residential subdivision, a total of eighteen (18) new addresses have been assigned. For a full inventory and description of the addresses, please refer to Table “A”. The enclosed Addressing Plan illustrates the proper use and placement of the new addresses. Included in this addressing action, two existing addresses (i.e., 4440 and 4450 Peralta Blvd) are being rescinded since they are no longer required.

**Electronic copies of this letter and documentation will be posted to the City’s web site at [http://gis.ci.fremont.ca.us/addr/addr\\_proj.cfm](http://gis.ci.fremont.ca.us/addr/addr_proj.cfm) within 10 business days. The files will be stored under SP60-0157.**

**Documents available on Web Site:**

X	Notification Letter
X	Address Plan (map)
	AutoCAD Drawing

	Address Table
	G.I.S. Layer

In accordance with Title 15 (Buildings and Construction) Chapter 15.55 (House Numbering) of the Fremont Municipal Code, this letter serves as the notice of the addressing action affecting your property. The new address must be in use within ten (10) days of the receipt of this letter. For information on the size and location of address numbers on a building, please refer to the enclosed information sheet titled “ADDRESSING – Property Owner Responsibilities” and to Chapter 15.50 (Building Security) of the Title 15 (Buildings and Construction).

You will need to update your address records and outside address numbers as soon as possible for the purpose of rapid identification of your property in the event of an emergency. Any occupants and property owner of this parcel should review and update their records that are registered with the City (such as for building permit and/or business tax purposes). And, by copy of this letter, we are notifying

Dave Agee and Doug Cummins  
March 26, 2015

Page 2 of 4

the below-listed agencies and utility companies. However, be aware that some agencies may not update their records until notified by the property owner. Therefore, it is your responsibility to make sure that the appropriate agencies or businesses acknowledge the correct addresses.

**If you have any questions concerning this matter, please contact Ruby Wun at (phone) 510-494-4833 or (e-mail) [rwun@fremont.gov](mailto:rwun@fremont.gov).**

Sincerely,



Christine K. Frost  
GIS and Addressing Manager

Enclosures (hardcopy/paper): Address Plan - map (1) and Property Owner Responsibilities Information Sheet.

cc: **Paper copy mailed to:**  
Jay Deckord, Vice President, Warmington-Talamore Assoc., LLC, 3090 Pullman St, Costa Mesa, CA 92626

Alameda County Assessor's Office  
Alameda County Regional Emergency Communication Center - Livermore (Paul Morgan)  
Alameda County Regional Emergency Communication Center - Dublin (Joshua Harris)  
Alameda County Registrar of Voters  
Alameda County Water District (2)  
Alameda County 911 (Coordinator)  
Alameda County Main Post Office (Donna Canalin)  
Republic Services (Customer Service Manager)  
Fremont Main Post Office (David Epps) – zip code area 94536 / 94537 / 94555  
US Postal Service / AMS – PIQA (Debbie Horton)  
US Postal Service / AMS (Veronica Chavez)  
Fremont Unified School District (Facilities Director)  
Schoolworks (Kathy Reynolds)  
Lynx Technologies  
Pacific Gas & Electric (Jessica Jones / Service Planning Dept.) (2)  
AT&T – Engineering  
AT&T – Database Center / SLIC  
Union Sanitary District (2)

**Sent via e-mail:**

Fremont Community Development - Site Plan Architectural Review (BPSPAR)  
Fremont Community Development – Fire & Life Safety (Howard Hancock)  
Fremont Plans & Permits  
Fremont Environmental Services (Lori Marra)

Fremont GIS (Ruby Wun; file copy - letter only)

**LOCATIONAL MAP**  
**(For reference only – see official addressing map for actual/correct address)**

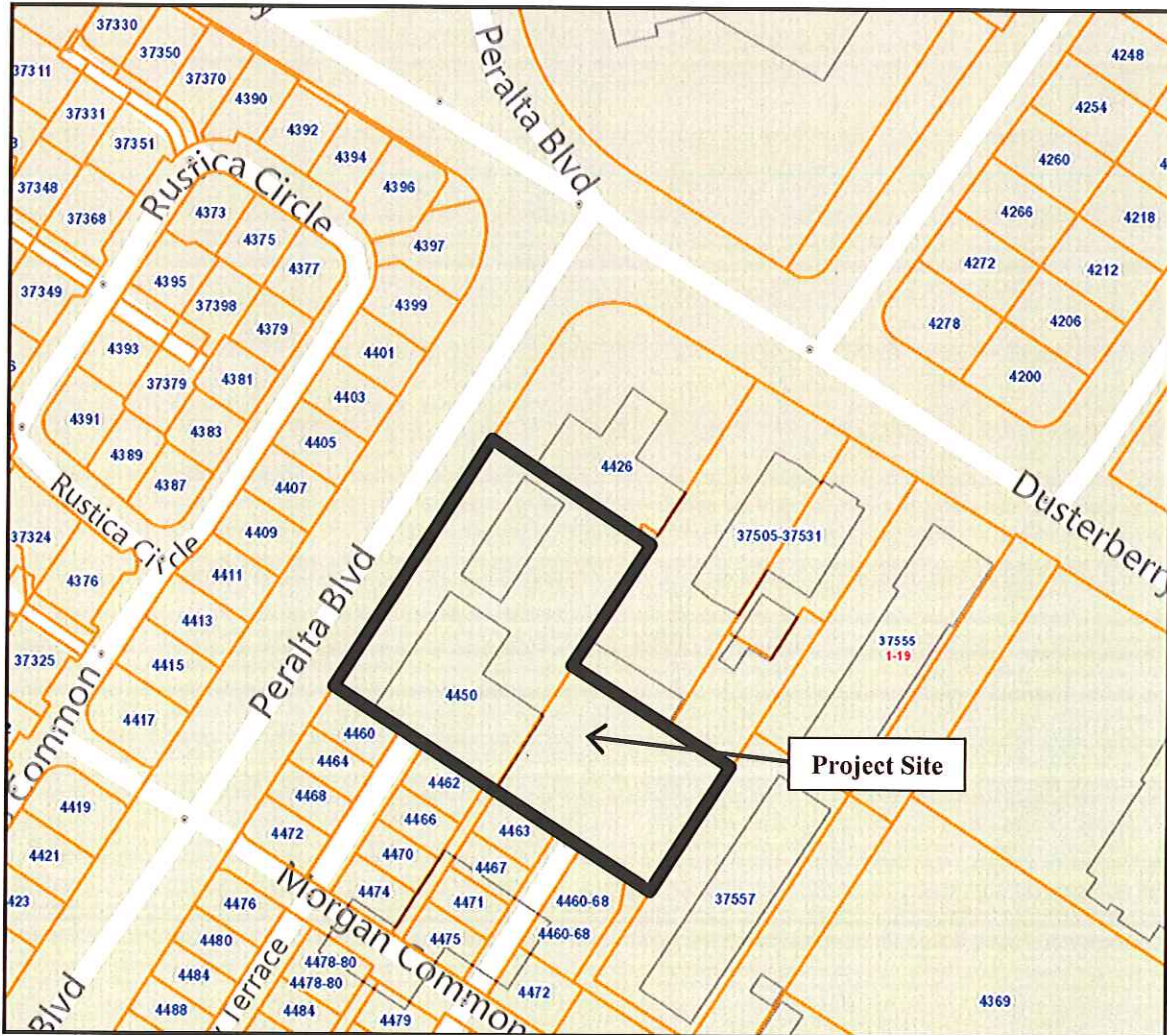

**TABLE A:**

Record	Address No.	Street Name	Zip Code	Subdivision No.	Lot No	Address Type	Address Status
1	4430	Kennett Ter	94536	TR 8182	Lot 6	Single Family Home RES   SF	New
2	4431	Kennett Ter	94536	TR 8182	Lot 5	Single Family Home RES   SF	New
3	4434	Kennett Ter	94536	TR 8182	Lot 7	Single Family Home RES   SF	New
4	4435	Kennett Ter	94536	TR 8182	Lot 4	Single Family Home RES   SF	New
5	4438	Kennett Ter	94536	TR 8182	Lot 8	Single Family Home RES   SF	New
6	4439	Kennett Ter	94536	TR 8182	Lot 3	Single Family Home RES   SF	New
7	4442	Kennett Ter	94536	TR 8182	Lot 9	Single Family Home RES   SF	New
8	4443	Kennett Ter	94536	TR 8182	Lot 2	Single Family Home RES   SF	New
9	4446	Kennett Ter	94536	TR 8182	Lot 10	Single Family Home RES   SF	New
10	4447	Kennett Ter	94536	TR 8182	Lot 1	Single Family Home RES   SF	New
11	37423	Talamore Cmn	94536	TR 8182	Lot 16	Single Family Home RES   SF	New
12	37427	Talamore Cmn	94536	TR 8182	Lot 15	Single Family Home RES   SF	New
13	37431	Talamore Cmn	94536	TR 8182	Lot 14	Single Family Home RES   SF	New
14	37432	Talamore Cmn	94536	TR 8182	Parcel B	Common Area Parcel RES   COMMON	New
15	37435	Talamore Cmn	94536	TR 8182	Lot 13	Single Family Home RES   SF	New
16	37436	Talamore Cmn	94536	TR 8182	Lot 11	Single Family Home RES   SF	New
17	37439	Talamore Cmn	94536	TR 8182	Lot 13	Common Area Irrigation Meter MISC   UTIL	New
18	37440	Talamore Cmn	94536	TR 8182	Lot 12	Single Family Home RES   SF	New
19	4440	Peralta Blvd	94536			Former address associated with project site	Rescinded
20	4450	Peralta Blvd	94536			Former address associated with project site	Rescinded