

ADDRESS CHRONOLOGY

- Parcel address issued at time of initial development: 1954
- Address issued to Accessory Dwelling Unit: 3/25/2024 (RC)

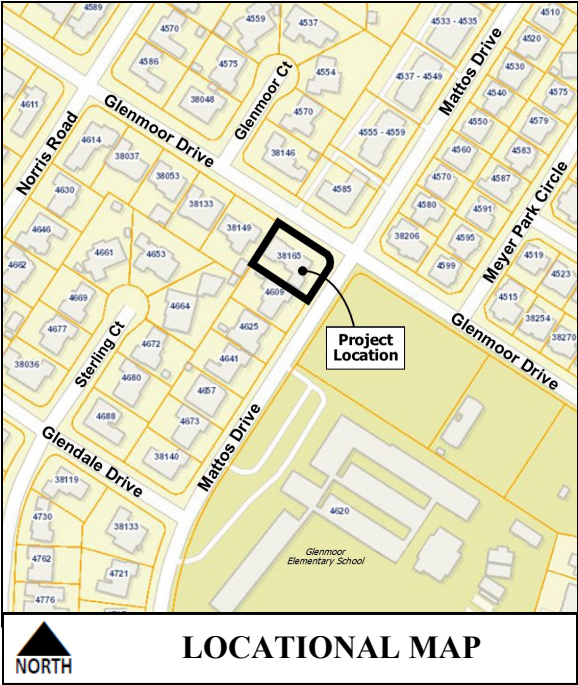

New
38163 Glenmoor Dr
(Accessory Dwelling Unit)

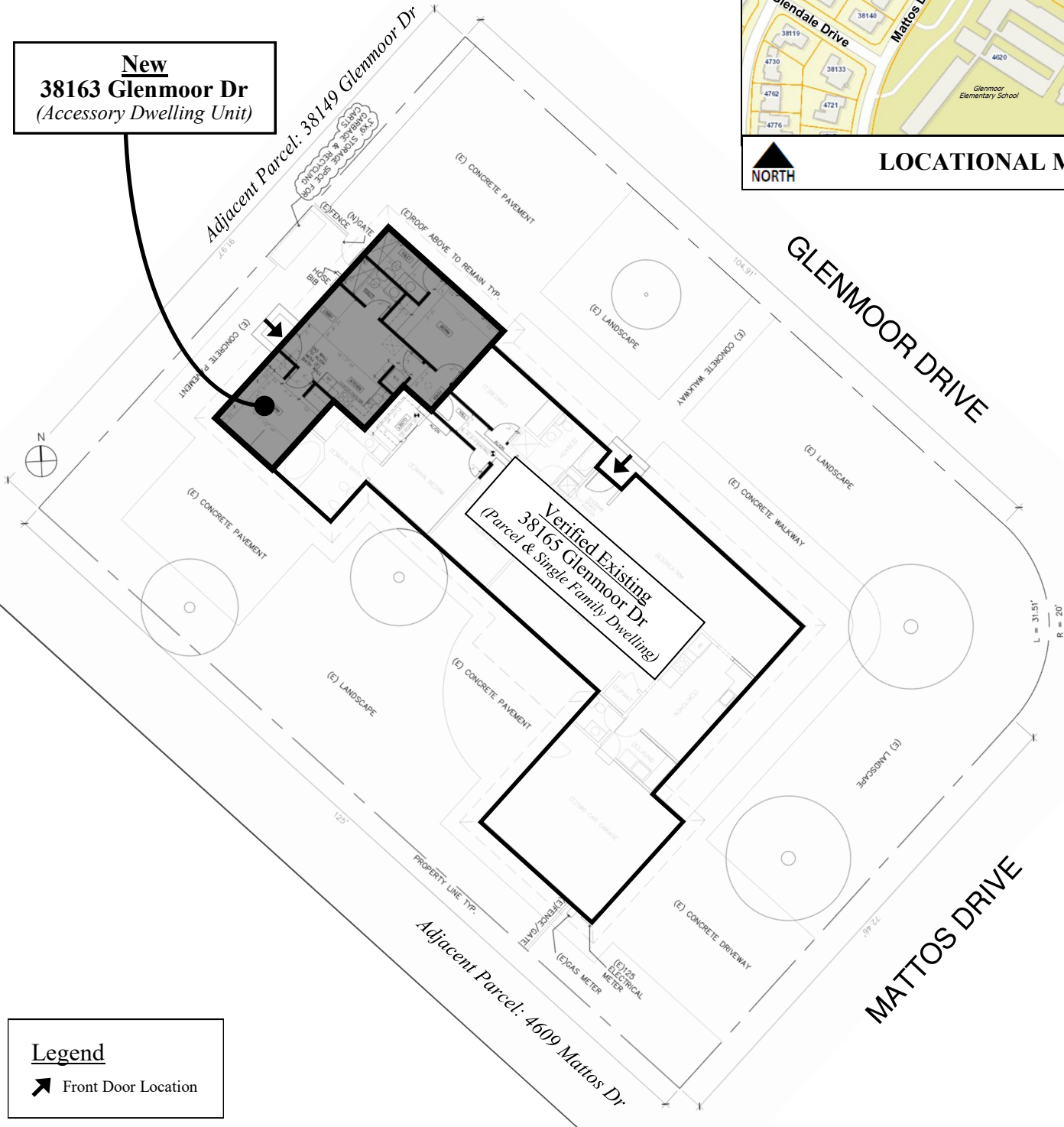

Legend

➤ Front Door Location



FOR ADDRESSING PURPOSES ONLY

SP60-0218 3/25/2024 (RC)