



**FOR ADDRESSING PURPOSES ONLY**

SP66-0064 4/30/2009 RC

**Addressing Chronology:**

- (1) Initial addressing at the time of construction in 1975.
- (2) Tenant space addresses assigned on 4/30/2009.

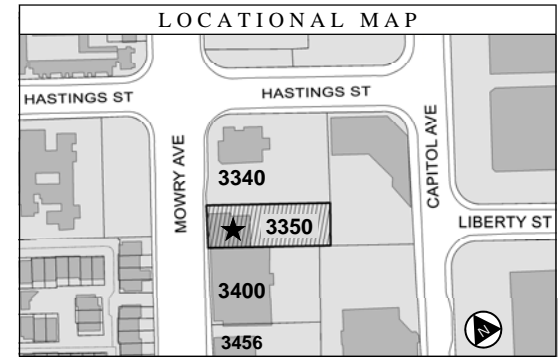

**Building & PG&E Meter Address**  
**3350 MOWRY AVENUE**  
 (Existing Address)



EXISTING WATER METER

MOWRY AVE

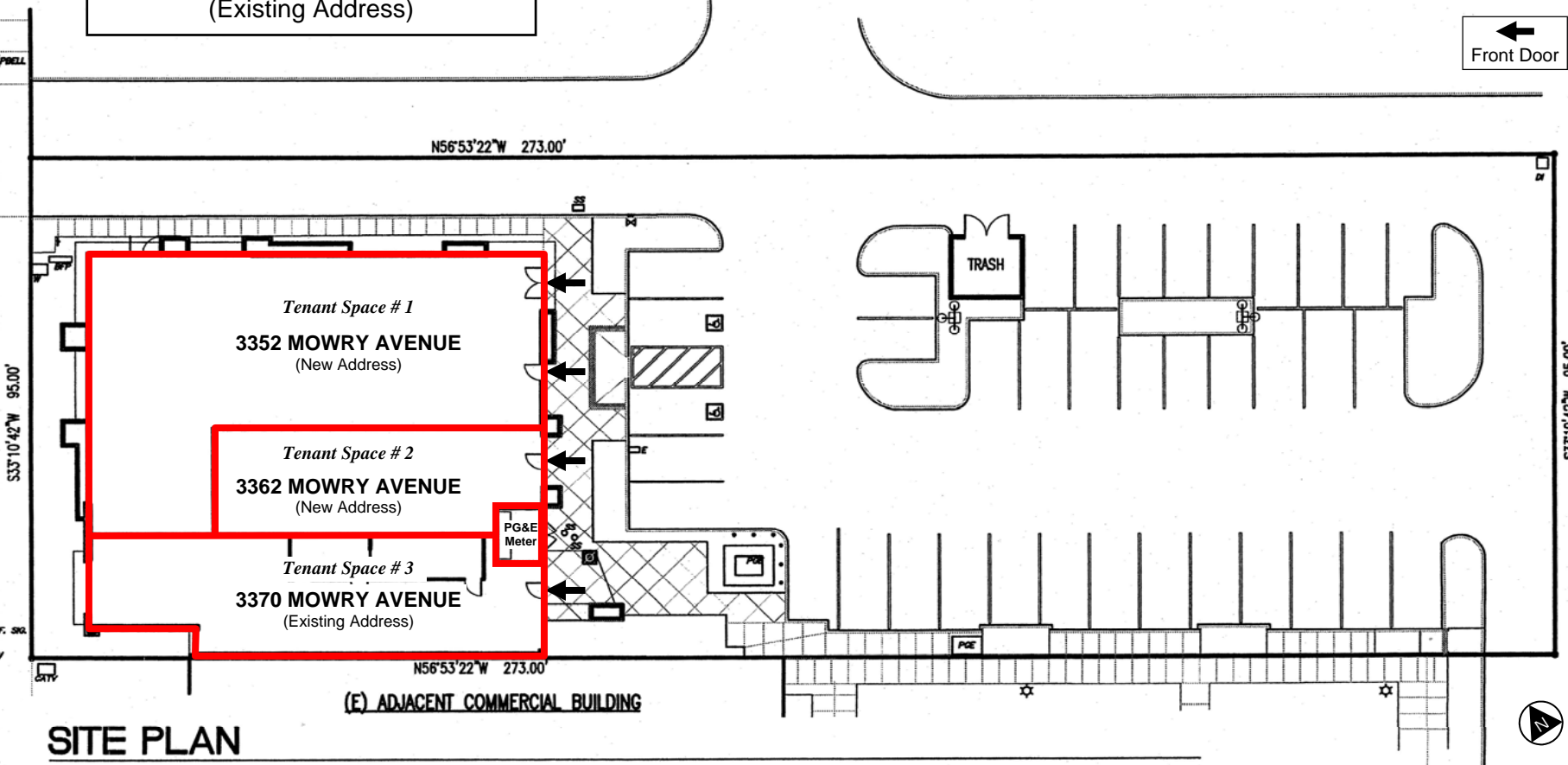

**SITE PLAN**

