

## ADDRESS CHRONOLOGY

- Initial addressing at time of original development: 11/14/1988 (JC)
- Address verification: 10/7/2011 (RW)
- Addresses issued to TR 8279 and rescinding four (4) existing addresses: 6/24/2016 (RW)
- Changes to common area utility meters: 8/22/2016 (RW)
- First floor residential condominium units in Bldgs A/B to reflect front door orientation to Heart Common and Jubilee Common: 8/21/2017 (RW)
- Address issued to new commercial condo unit in Bldg B: 5/13/2024 (RC)

CAPITOL AVENUE

MEMORIAL STREET

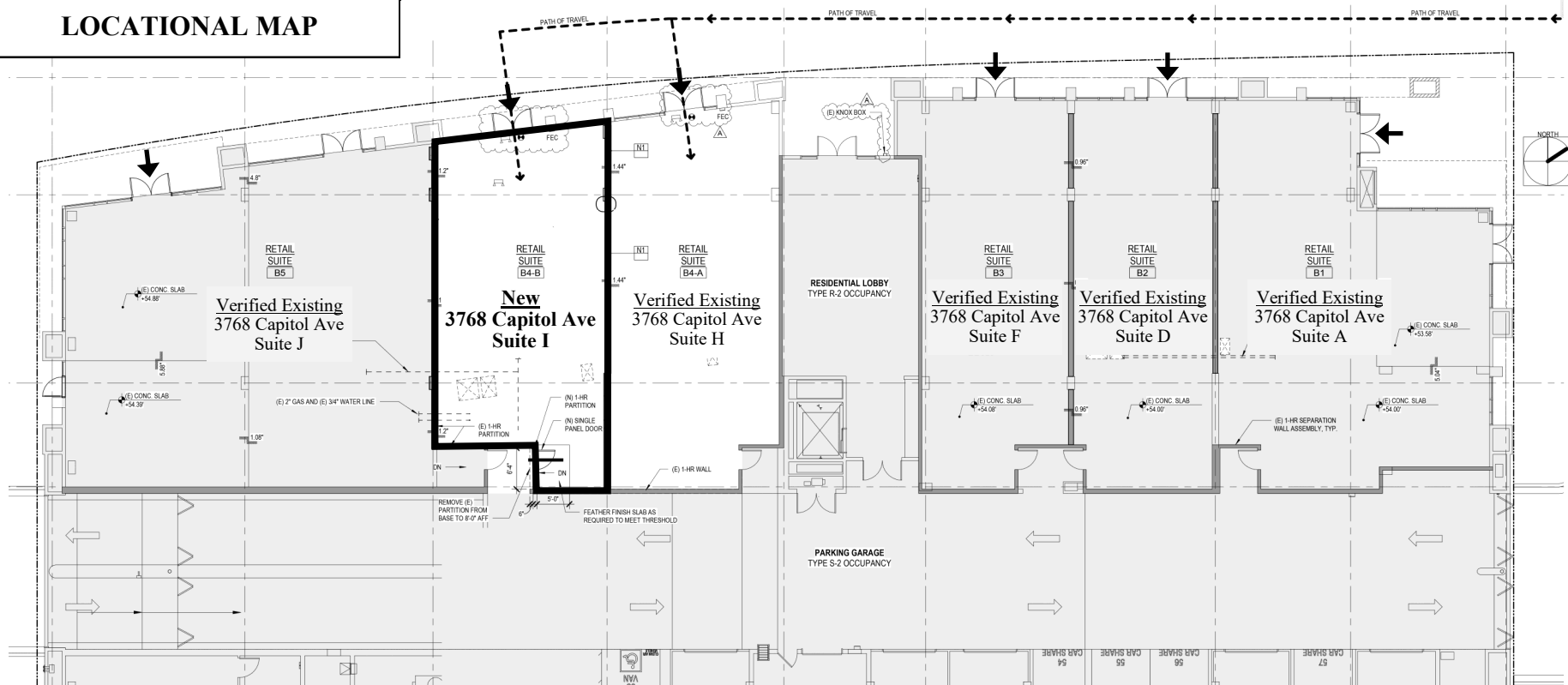

**FOR ADDRESSING PURPOSES ONLY**

SP66-0121 5/13/2024 (RC)



**Legend**

➔ Front Door Location