

# ADDRESS CHRONOLOGY

- Parcel address issued at time of initial development: 1912
- Address issued to Accessory Dwelling Unit: 12/19/2022 (RC)

## MISSION BLVD

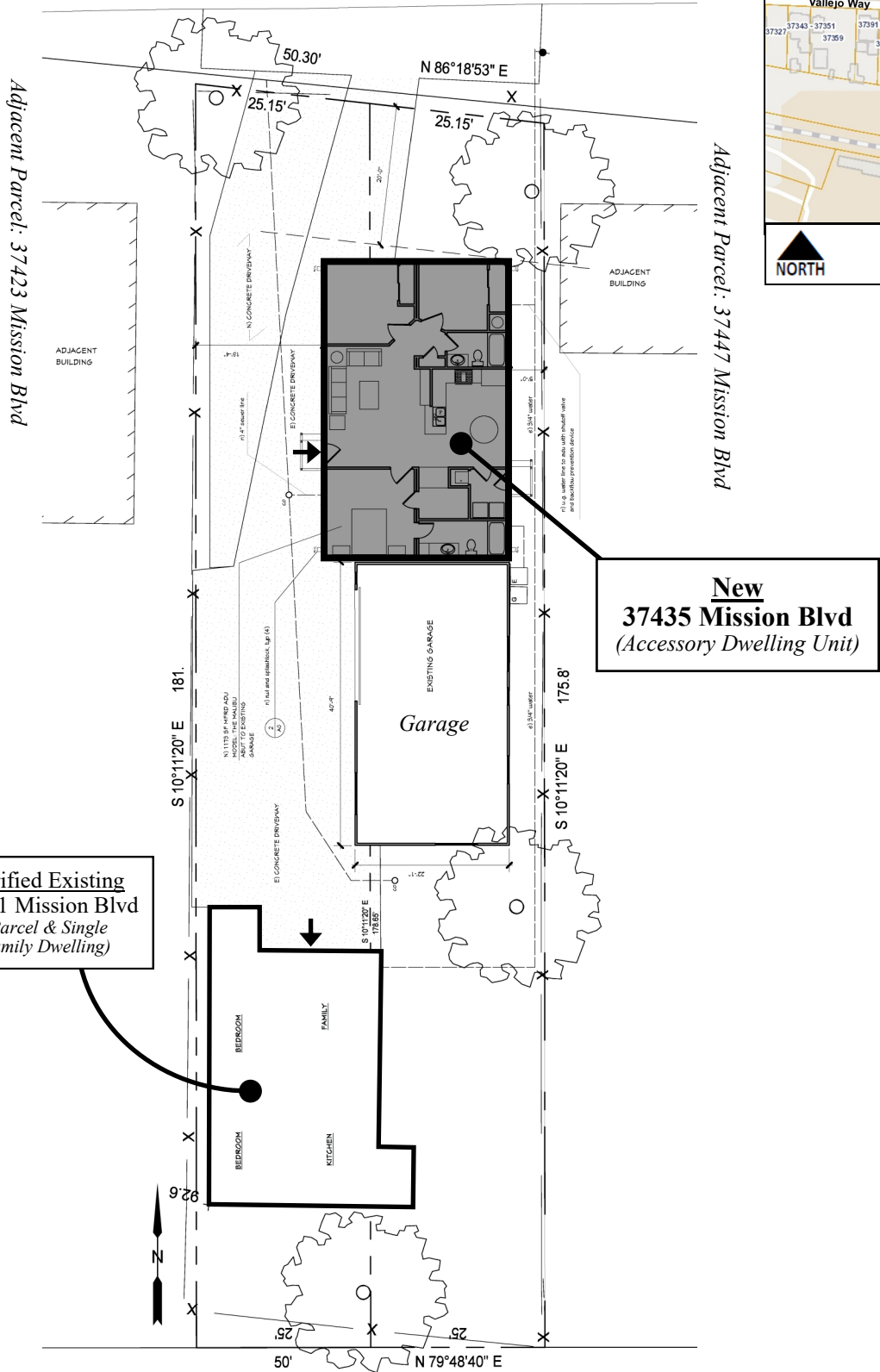

LOCATIONAL MAP

**New**  
**37435 Mission Blvd**  
*(Accessory Dwelling Unit)*

**Verified Existing**  
**37431 Mission Blvd**  
*(Parcel & Single Family Dwelling)*

**Legend**  
 Front Door Location



# FOR ADDRESSING PURPOSES ONLY

SP66-0135 12/19/2022 (RC)