

FIRST FLOOR

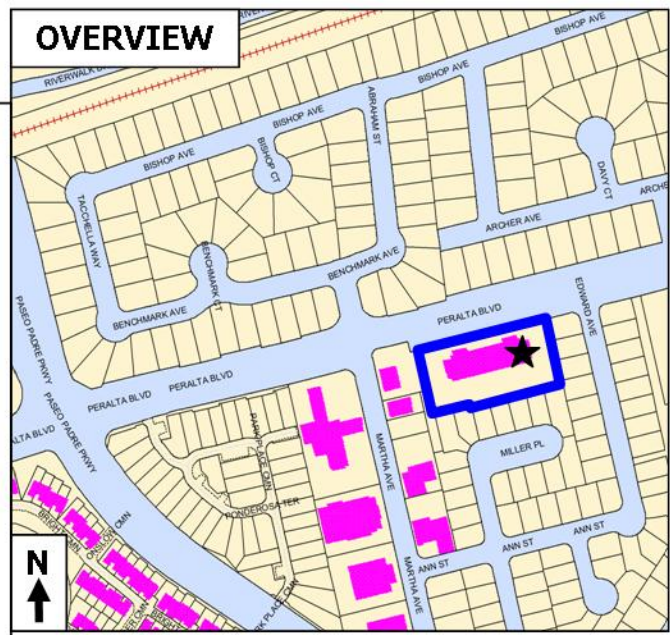

Building Address
2450 PERALTA BLVD

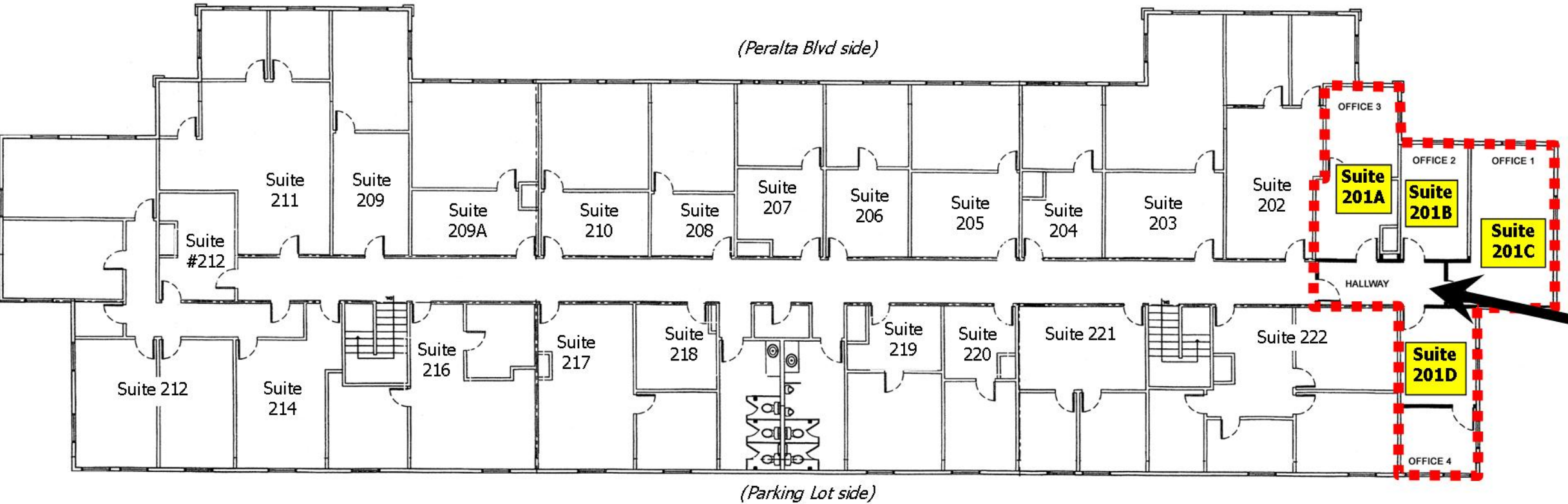

SECOND FLOOR

NOTE: Suite numbers shall be in a sequential pattern. It is recognized that existing Suites 118, 209, 209A and 210 are currently out of sequence. When these suites are vacated, that they will need re-assignment to new suite numbers.

NEW SUITES: Suites 201A, 201B, 201C, and 201D.

Door to suites are to be clearly labeled with their corresponding suite numbers.

FOR ADDRESSING PURPOSES ONLY
SP66-0215 RC/RW 1/11/2008