

**ADDRESS CHRONOLOGY**

- Initial addressing at time of original development: 1928
- Addresses issued for Tract 7938; and, existing addresses of 3803 and 3851 Eggers Drive rescinded: 12/18/2014 (RW)

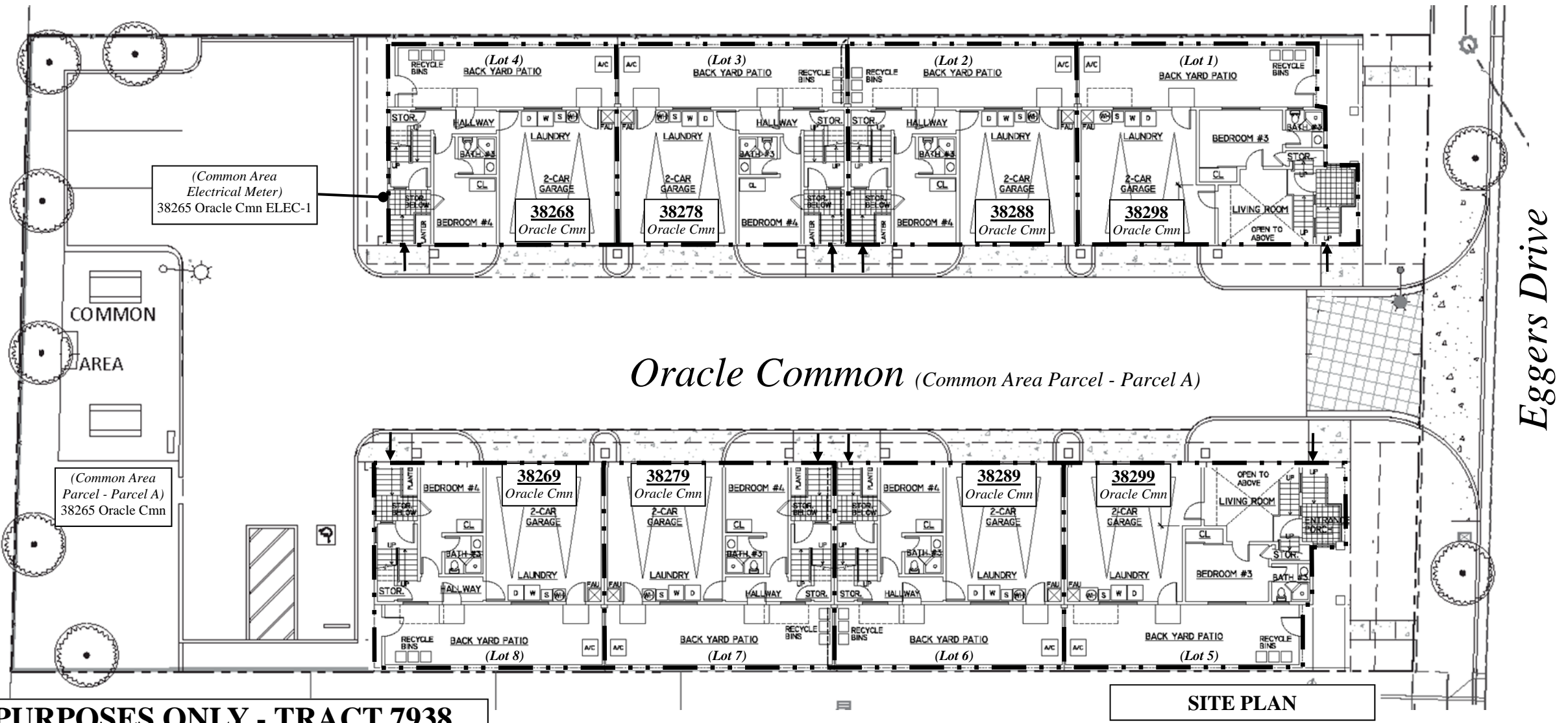

**LEGEND:**

- · — Property Line
- Unit front door



**FOR ADDRESSING PURPOSES ONLY - TRACT 7938**

SP66-0217 12/18/2014 (RW)

**SITE PLAN**