

- NOTE:**
- Existing addresses to be relocated and re-used:
 - 38799 Paseo Padre Pkwy (for use by monument sign located at corner of Paseo Padre Pkwy and Mowry Ave)
 - 3161 Mowry Ave (reserved for use by future tenant space)
 - Existing address to be rescinded:
 - 3101 Mowry Ave

- ADDRESS CHRONOLOGY**
- Original addressing issued at time of initial development: *(date unknown)*
 - Assignment of 5 new addresses, relocation of 1 existing address, rescind 1 existing address, and the reservation of 1 existing address *(to be assigned a new location at a later time)* for Parcel Map 10102: 11/30/2012 (RW)

LEGEND:

- Lot boundary
- Main entrance into tenant spaces

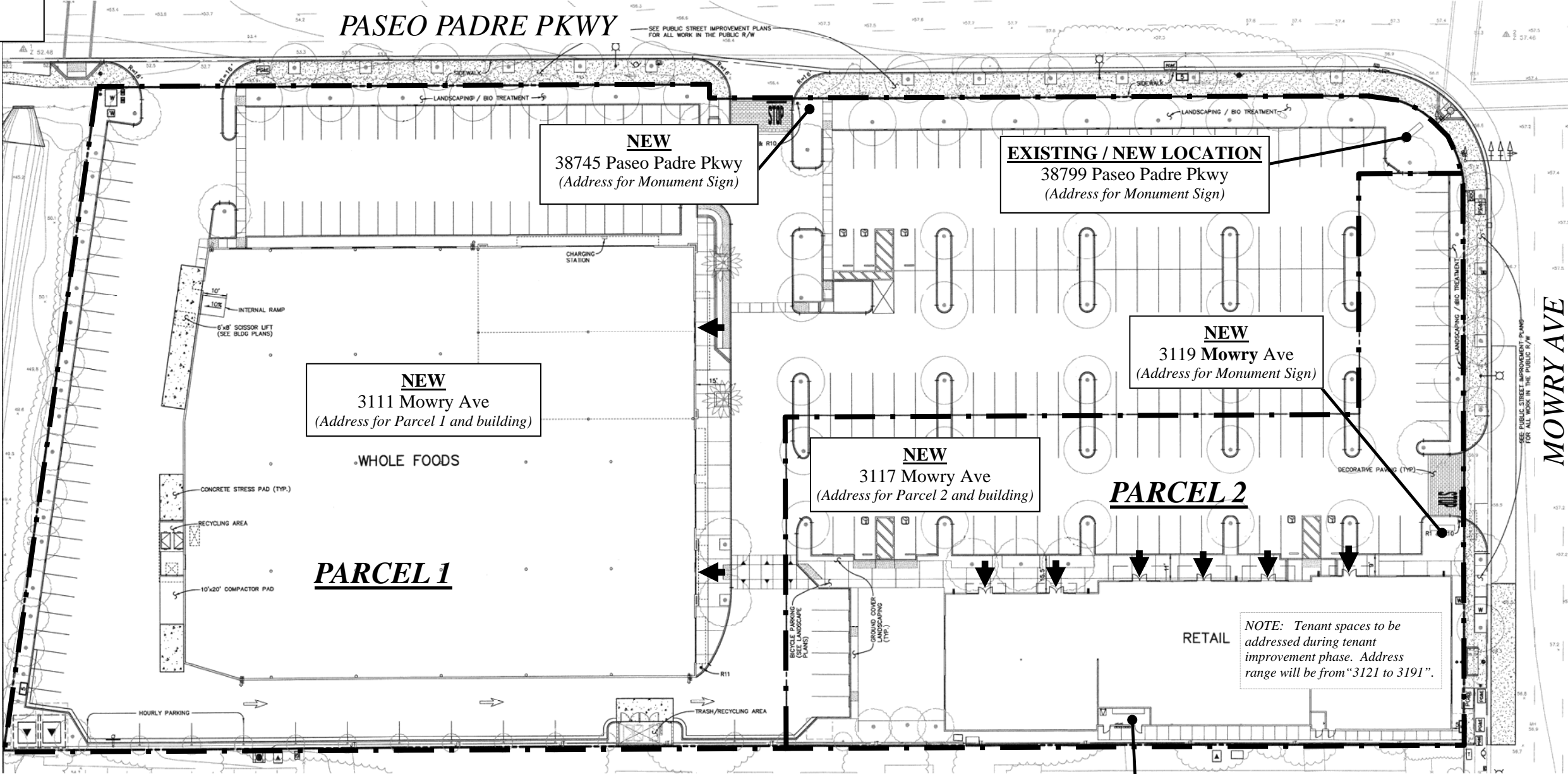

NEW
3195 Mowry Avenue
(Address for Electrical Rm/meter location)

