

Project Site

Parcel View



Aerial View



LOCATIONAL MAP

ADDRESS CHRONOLOGY

- Original addressing issued at time of initial development: *(date unknown)*
- Assignment of 5 new addresses, relocation of 1 existing address, rescind 1 existing address, and the reservation of 1 existing address *(to be assigned a new location at a later time)* for Parcel Map 10102: 11/30/2012 (RW)
- Address issued for new traffic signal service cabinet: 2/4/2013 (RW)

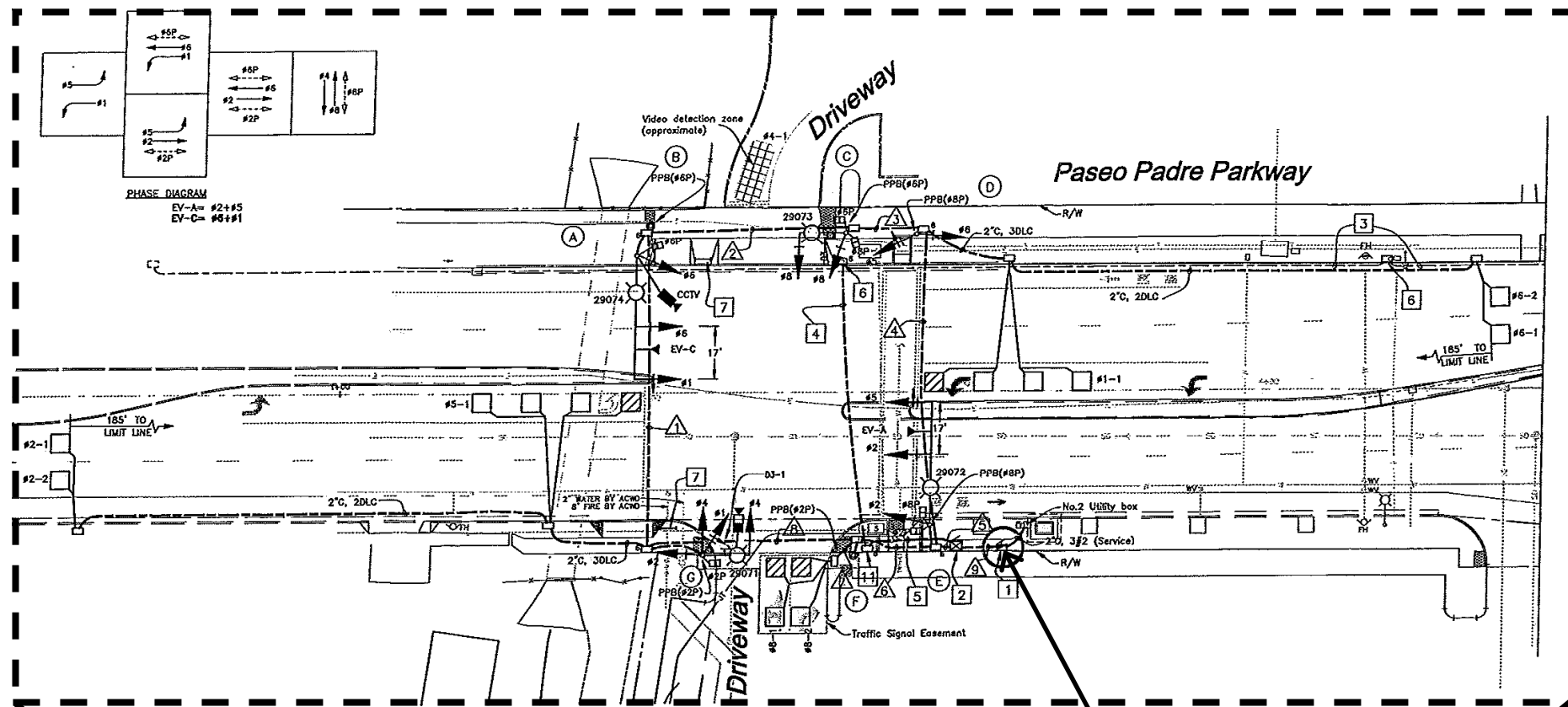

NEW
38711 Paseo Padre Pkwy
(PG&E Service Point/Enclosure for traffic signal)

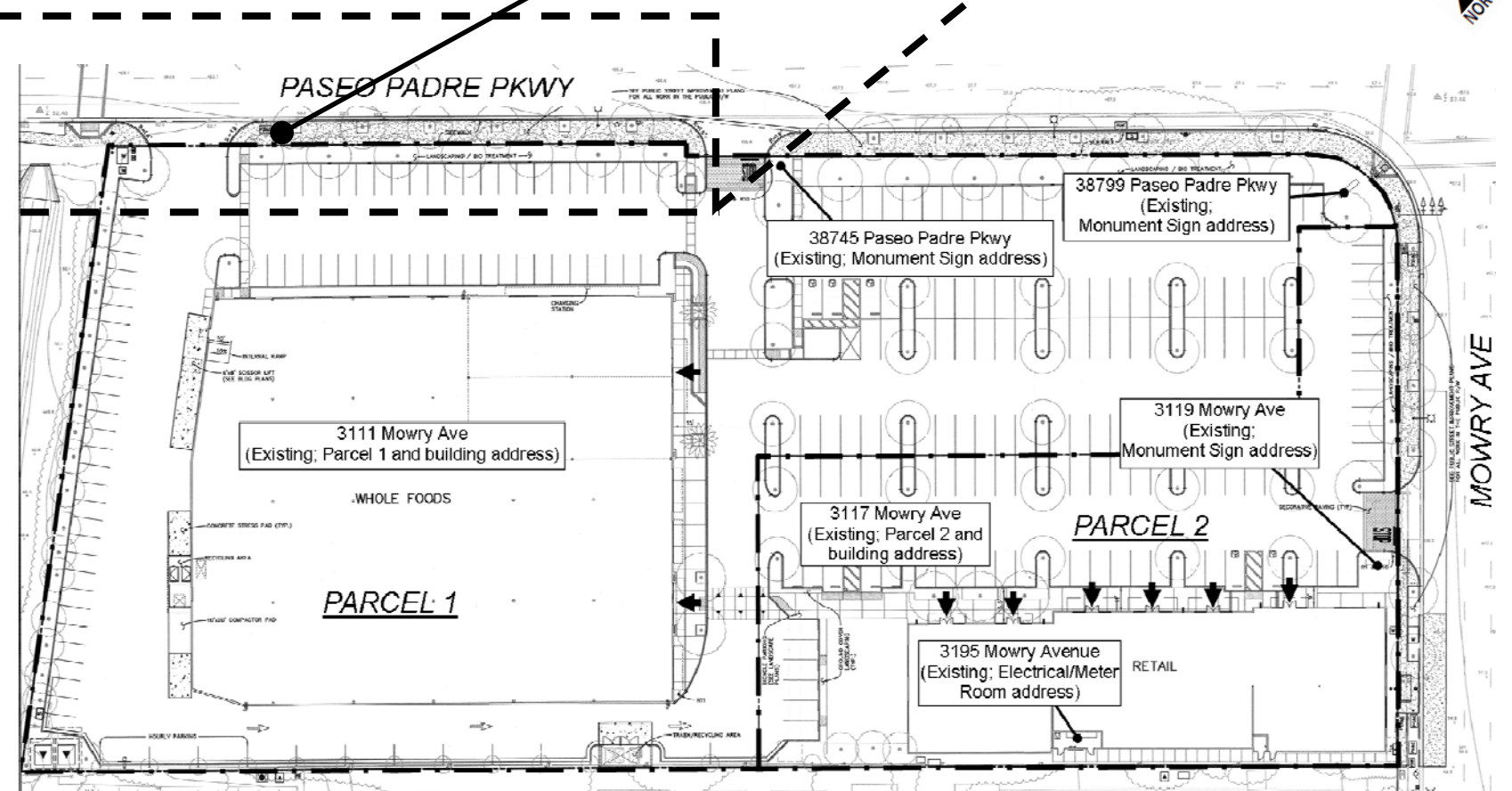

FOR ADDRESSING PURPOSES ONLY

SP66-0236 2/5/2013 (RW)