



P.L. 53' N33°28'0"E

New
4717 Serra Ave
(Jr. Accessory Dwelling Unit)

27'-9"

8'-0"

22'-9"

6'-1"

P.L. 107.77 S57°04'20"E

P.L. 107.44 S57°04'20"E

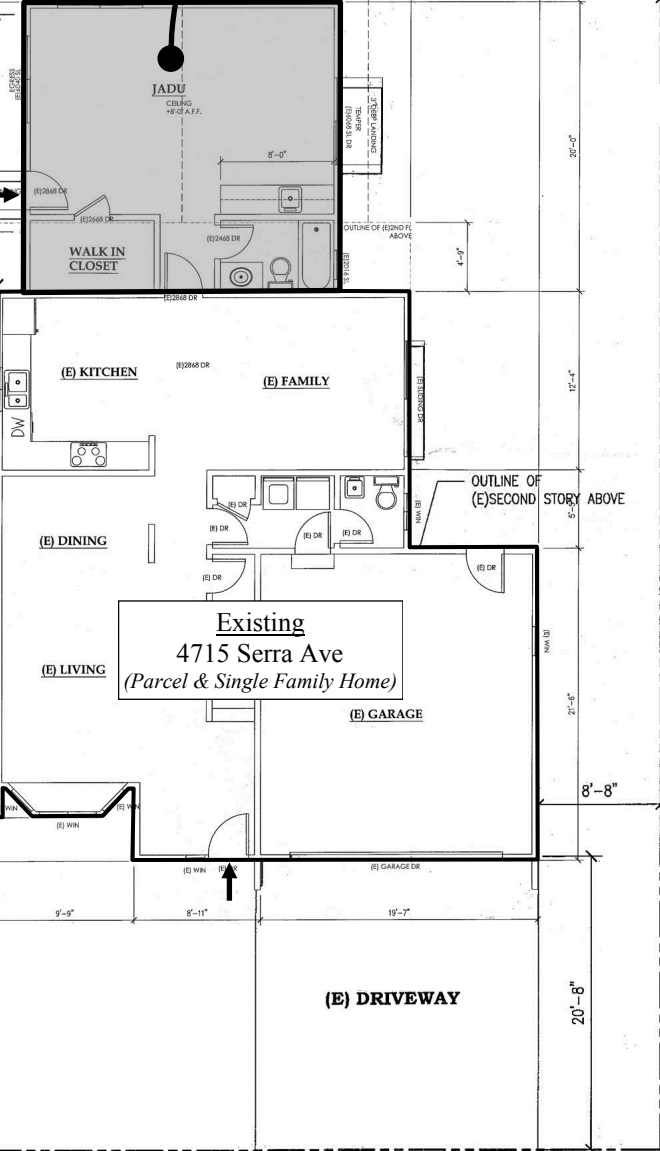

P.L. 53' N33°28'0"E

Serra Avenue

Adjacent Parcel: 4729 Serra Avenue

Adjacent Parcel: 4701 Serra Avenue



LOCATIONAL MAP

LEGEND

Front Door Location

ADDRESS CHRONOLOGY

- Property/parcel address issued at time of initial development: 1977.
- Address issued to junior accessory dwelling unit: 10/2/2017 (RC)



FOR ADDRESSING PURPOSES ONLY

SP66-0251 10/2/2017 (RC)