



Date: July 15, 2016

To: Eric Okamoto
 Eric Okamoto, M.D., Inc.
 39380 Civic Center Dr., Ste B
 Fremont, CA 94538

Requestor: n/a
 Discretionary Rev: n/a
 Permitting File#: n/a
 SP#: 72-0002
 APN#: 525 085003500
 Zip Code: 94538
 Fire ESZ | Box/S-Dist: 09 – 481 | 9-1 / 91A1
 Address For: Business

Re: Suite Addresses for two tenant spaces – 2675 Stevenson Blvd Suites 100 and 200

To Whom It May Concern:

In response to your request for addresses needed for two tenant spaces, a total of two (2) new suite numbers have been assigned. For a full inventory and description of the addresses, please refer to Table “A”. The enclosed Addressing Plan illustrates the proper use and placement of the new addresses.

Electronic copies of this letter and documentation will be posted to the City’s web site at http://gis.ci.fremont.ca.us/addr/addr_proj.cfm within 10 business days. The files will be stored under SP72-0002.

Documents available on Web Site:

X	Notification Letter		Address Table
X	Address Plan (map)		G.I.S. Layer
	AutoCAD Drawing		

In accordance with Title 15 (Buildings and Construction) Chapter 15.55 (House Numbering) of the Fremont Municipal Code, this letter serves as the notice of the addressing action affecting your property. The new address must be in use within ten (10) days of the receipt of this letter. For information on the size and location of address numbers on a building, please refer to the enclosed information sheet titled “ADDRESSING – Property Owner Responsibilities” and to Chapter 15.50 (Building Security) of the Title 15 (Buildings and Construction).

You will need to update your address records and outside address numbers as soon as possible for the purpose of rapid identification of your property in the event of an emergency. Any occupants and property owner of this parcel should review and update their records that are registered with the City (such as for building permit and/or business tax purposes). And, by copy of this letter, we are notifying the below-listed agencies and utility companies. However, be aware that some agencies may not update their records until notified by the property owner. Therefore, it is your responsibility to make sure that the appropriate agencies or businesses acknowledge the correct addresses.

If you have any questions concerning this matter, please contact Ruby Wun at (phone) 510-494-4833 or (e-mail) rwun@fremont.gov.

Sincerely,



Christine K. Frost
GIS and Addressing Manager

Enclosures (hardcopy/paper): Address Plan - map (1) and Property Owner Responsibilities Information Sheet.

cc: **Paper copy mailed to:**

Alameda County Regional Emergency Communication Center - Livermore
Alameda County Regional Emergency Communication Center - Dublin (Joshua Harris)
Alameda County Water District (2)
Alameda County 911 (Coordinator)
Alameda County Main Post Office (Donna Canalin)
Republic Services (Customer Service Manager)
Irvington Station Post Office (Areen Dhami) - zip code area 94538
US Postal Service / AMS – PIQA (Debbie Horton)
US Postal Service / AMS (Veronica Chavez)
Lynx Technologies
Pacific Gas & Electric (Jessica Jones / Service Planning Dept.) (2)
AT&T – Engineering
Union Sanitary District (2)

Sent via e-mail:

AT&T – Database Center / SLIC
Fremont Community Development - Site Plan Architectural Review (BPSPAR)
Fremont Community Development – Fire & Life Safety (Howard Hancock)
Fremont Plans & Permits
Fremont GIS (Ruby Wun; file copy - letter only)

LOCATIONAL MAP

(For reference only – see official addressing map for actual/correct address)

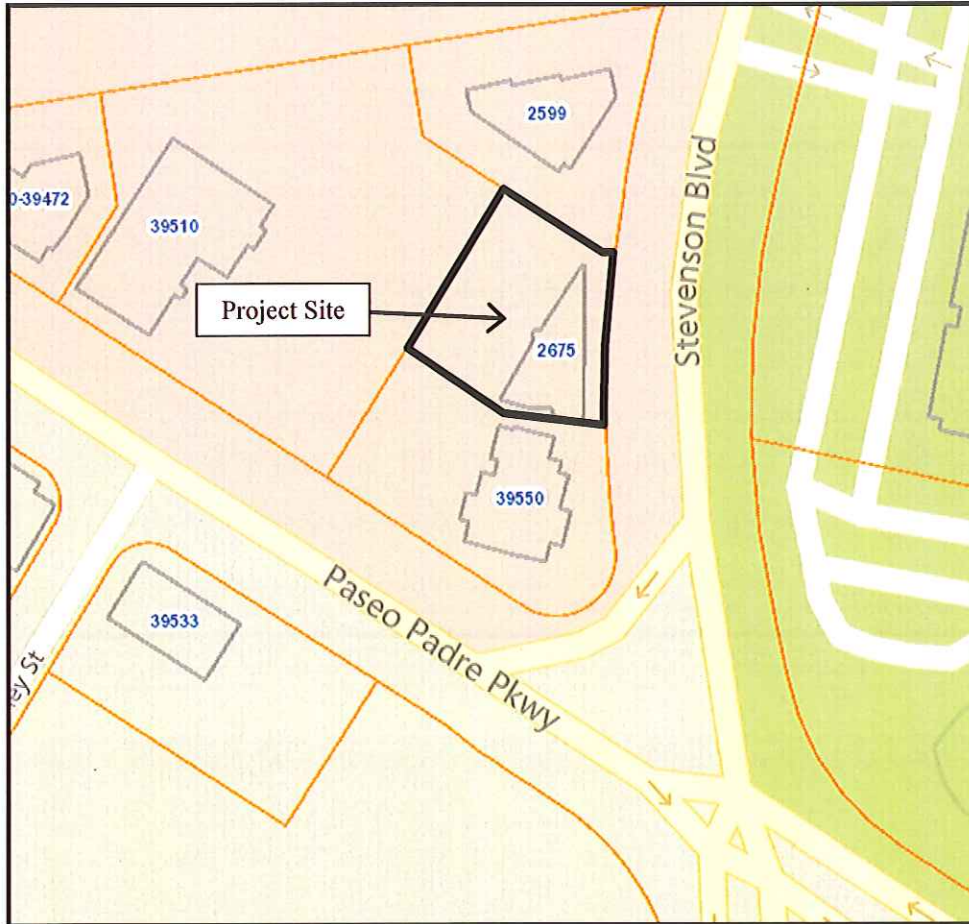

TABLE A:

Record	Address No.	Street Name	Unit No.	Zip Code	Address Type	Address Status
1	2675	Stevenson Blvd		94538	Property / Building address NRES PCL_BLDG_UTIL	Existing / Verified
2	2675	Stevenson Blvd	# 100	94538	Tenant Space NRES SPACE	NEW
3	2675	Stevenson Blvd	# 200	94538	Tenant space NRES SPACE	NEW