

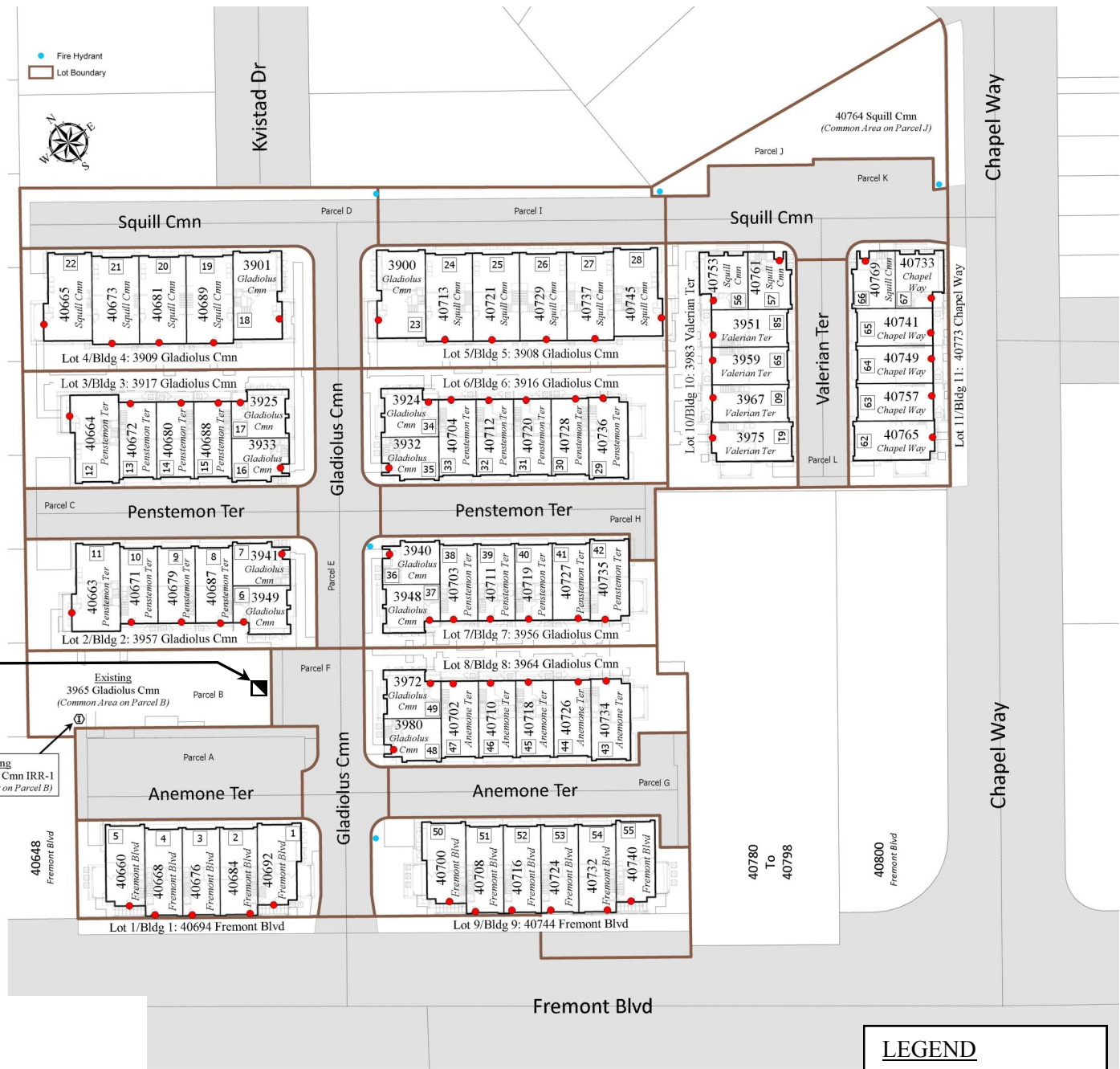

NEW
3965 Gladiolus Cmn Elec-1
(PG&E meter for CATV meter pedestal in common area - Parcel B)

*Existing
 3965 Gladiolus Cmn IRR-1
 (Irrigation Meter on Parcel B)*



ADDRESS CHRONOLOGY

- Addresses assigned to parcels at initial development: 1955.
- Issuance of addresses for Tract 8261: 7/12/2017 (RC)
- Address issued for PG&E Meter (CATV meter pedestal): 11/13/2017 (RC)



FOR ADDRESSING PURPOSES ONLY — TRACT 8261 *(address for PG&E meter)*
 SP72-0320 11/13/2017 (RC)

LEGEND	
4086 Squill Cmn	Lot Address
46 or Parcel A	Lot Number
●	Front Door
Ⓜ	Irrigation Meter
■	PG&E Meter