

ADDRESS CHRONOLOGY

- Parcel address issued at time of initial development: 1962
- Address issued for accessory dwelling unit: 7/6/2018 (RC)

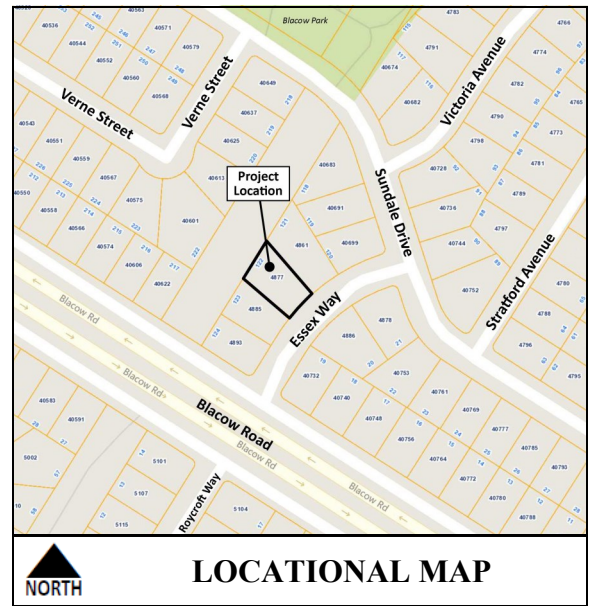

New
4875 Essex Way
(Accessory Dwelling Unit)

Existing
4877 Essex Way
(Parcel & Single Family Home)

LEGEND

➤ Front Door Location

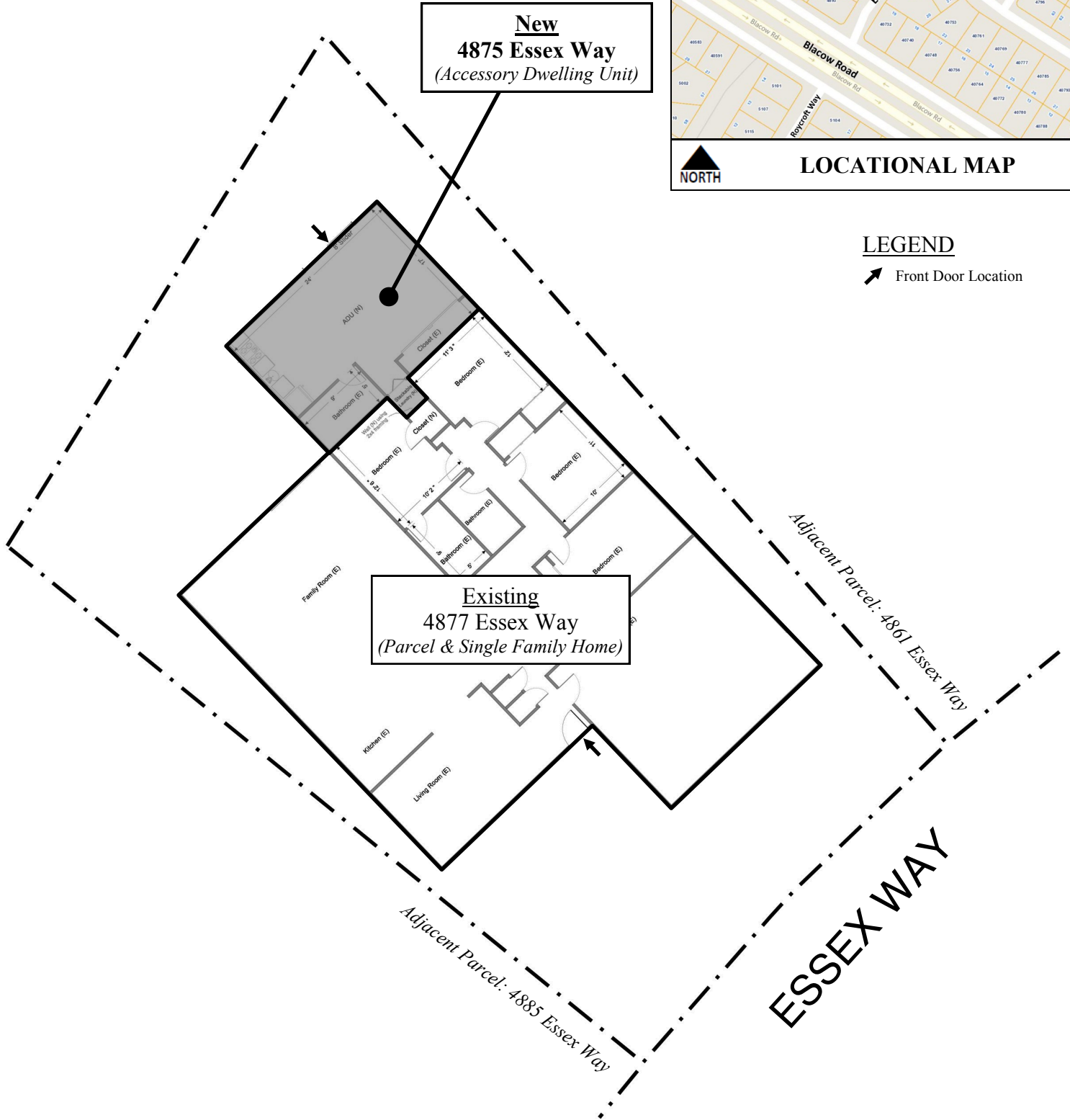

FOR ADDRESSING PURPOSES ONLY

SP72-0344 7/6/2018 (RC)