

Adjacent Parcel: 324 J St

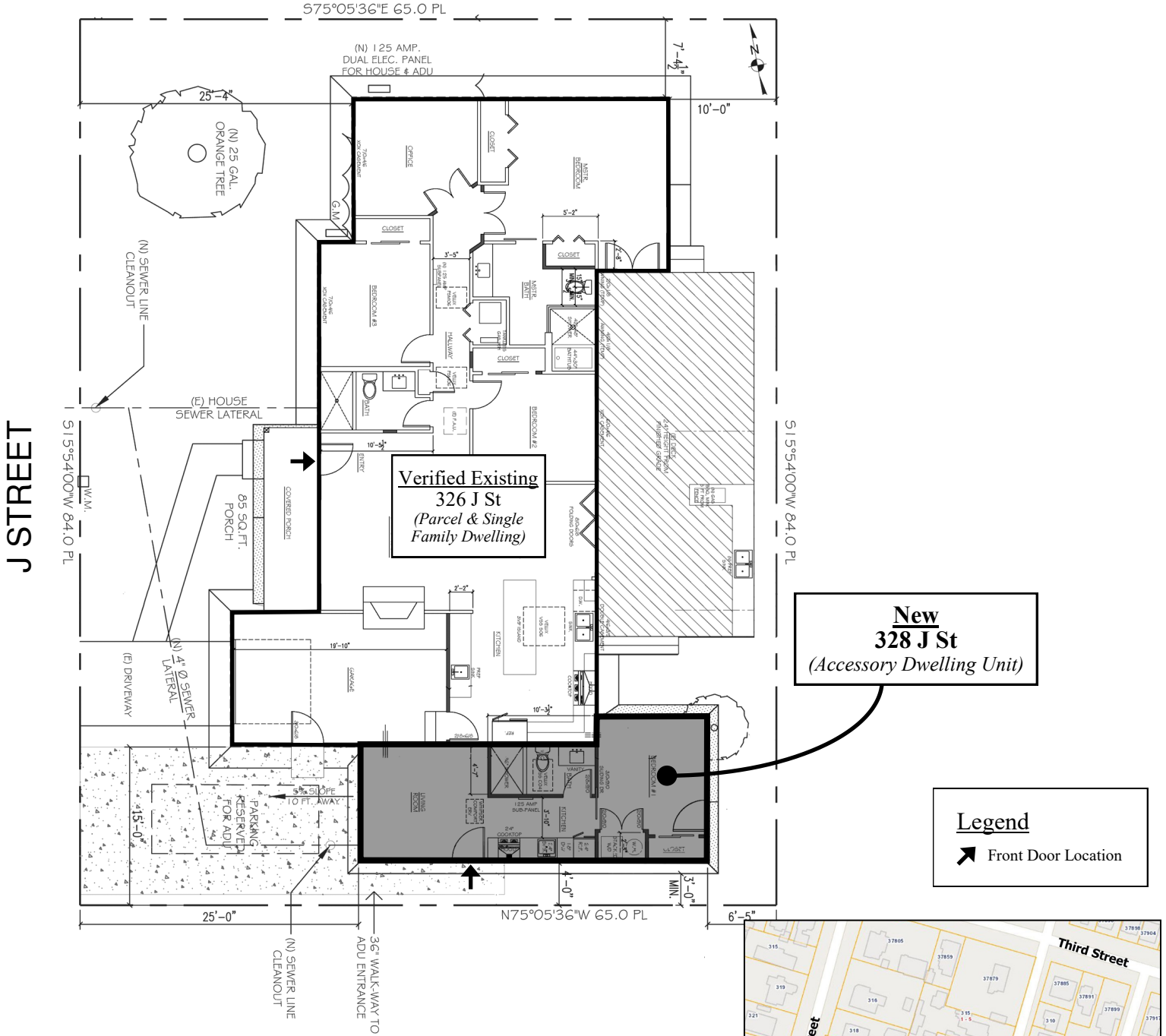

STREET J

**Verified Existing**  
326 J St  
(Parcel & Single Family Dwelling)

**New**  
328 J St  
(Accessory Dwelling Unit)

**Legend**  
➤ Front Door Location

Adjacent Parcel: 330 J St

**ADDRESS CHRONOLOGY**

- Parcel address issued at time of initial development: 1950
- Address issued to Accessory Dwelling Unit: 10/17/2022 (RC)

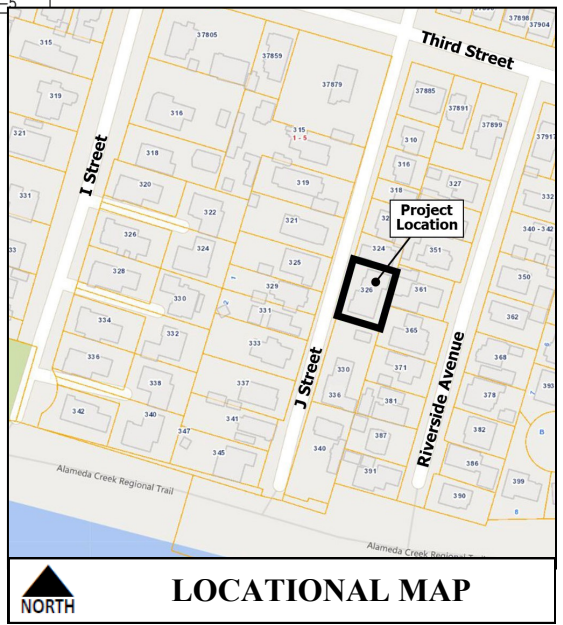

**LOCATIONAL MAP**



**FOR ADDRESSING PURPOSES ONLY**

SP72-0403 10/17/2022 (RC)