

LOCATIONAL MAP

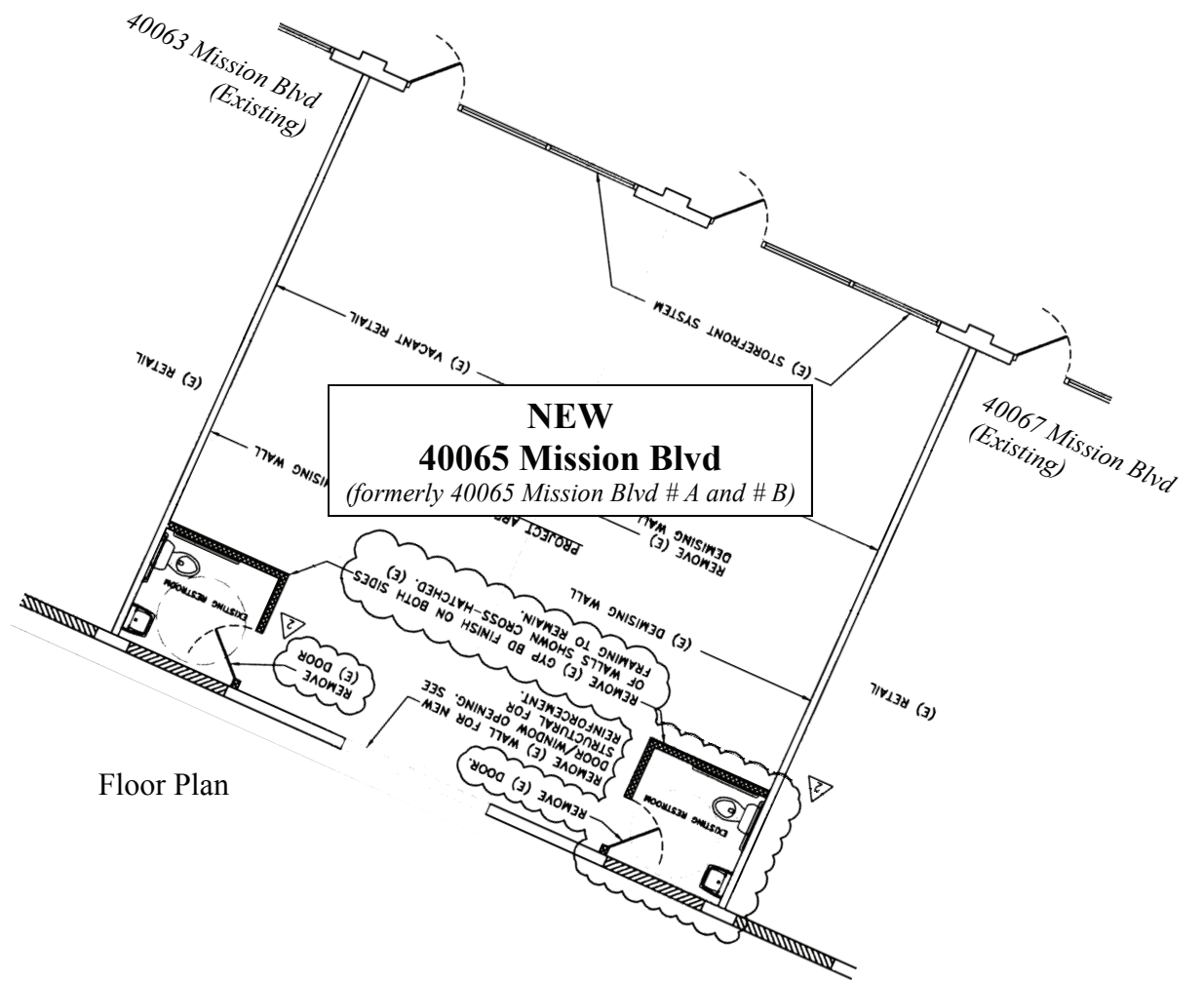

Floor Plan

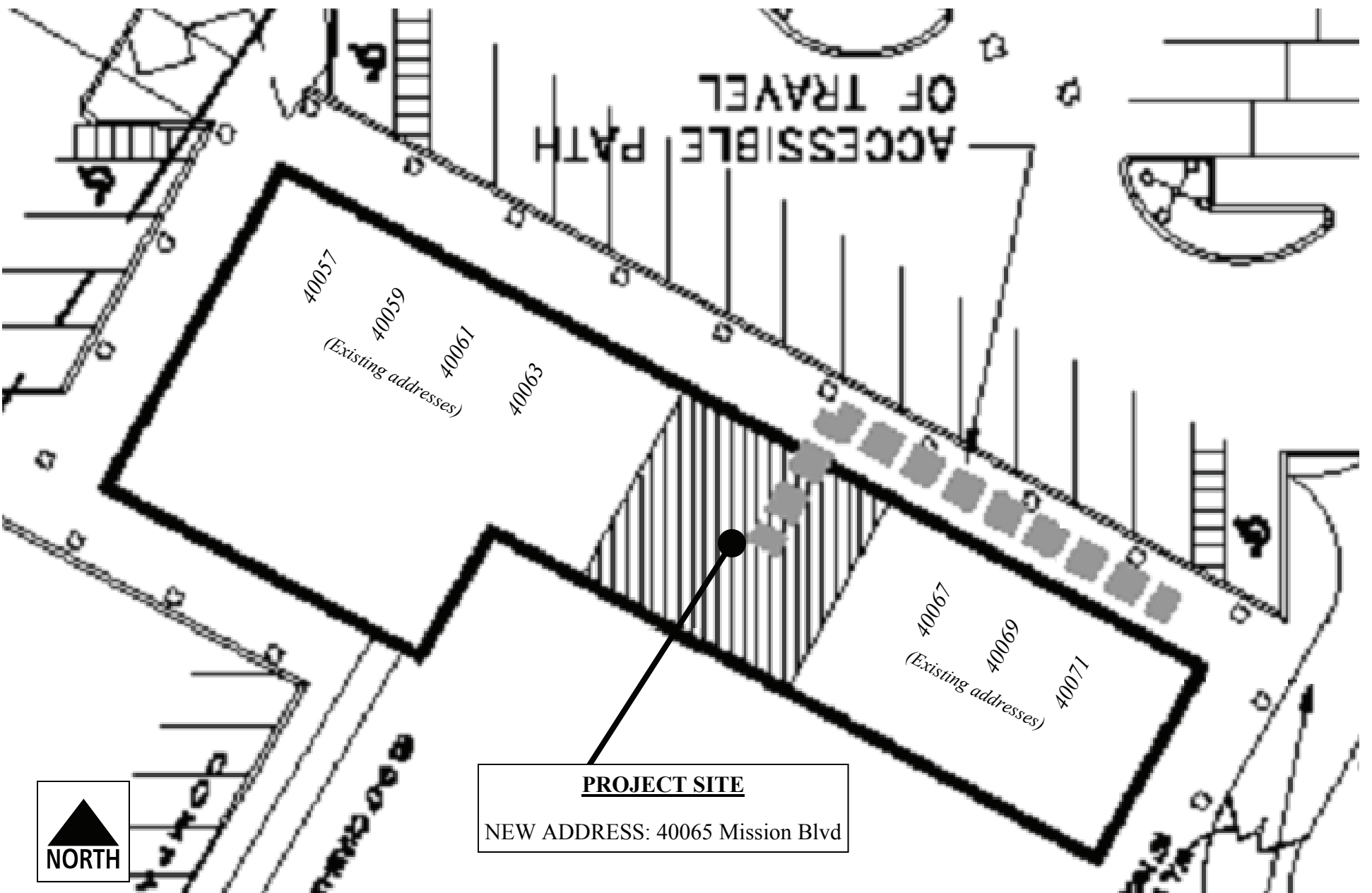

ADDRESS CHRONOLOGY

- Initial addressing at time of original development: 1971
- Addressing due to expansion of shopping center: 3/8/1985 (ME)
- Additional addresses issued: 6/24/1987 (JC)
- 40065A and 40065B Mission Blvd issued (to replace 40065 Mission Blvd): 4/03/1998 (ME)
- 39947 Mission Blvd issued: 5/5/2004 (RW)
- 39977 Mission Blvd issued: 3/28/2006 (RW)
- Assignment of new address of 40065 Mission Blvd and rescinding 40065 Mission Blvd # A and # B: 1/10/2011 (RW)



FOR ADDRESSING PURPOSES ONLY

SP78-0008 1/10/2011 (RW)