

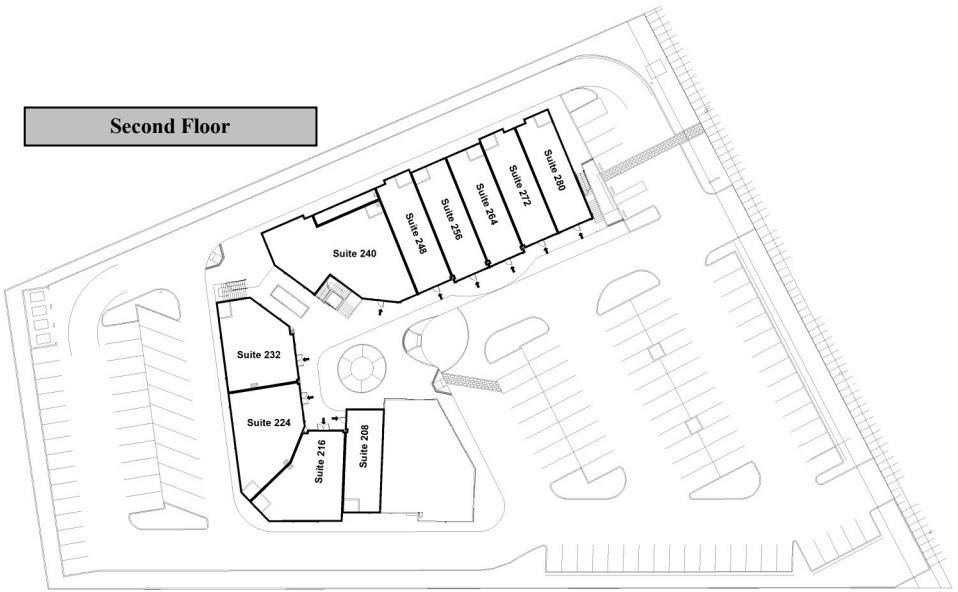

ADDRESS CHRONOLOGY

- Parcel address issued at time of initial development: 1971
- Addresses issued to new building and tenant spaces: 11/19/2008 (RC)
- Electrical meter addresses issued to Suite 100: 3/24/2025 (RC)

Second Floor



New
2090 Warm Springs Ct Elec-2
(Electrical Meter for Suite 100)

New
2090 Warm Springs Ct Elec-1
(Electrical Meter for Suite 100)

Adjacent Parcel: 2120 Warm Springs Ct

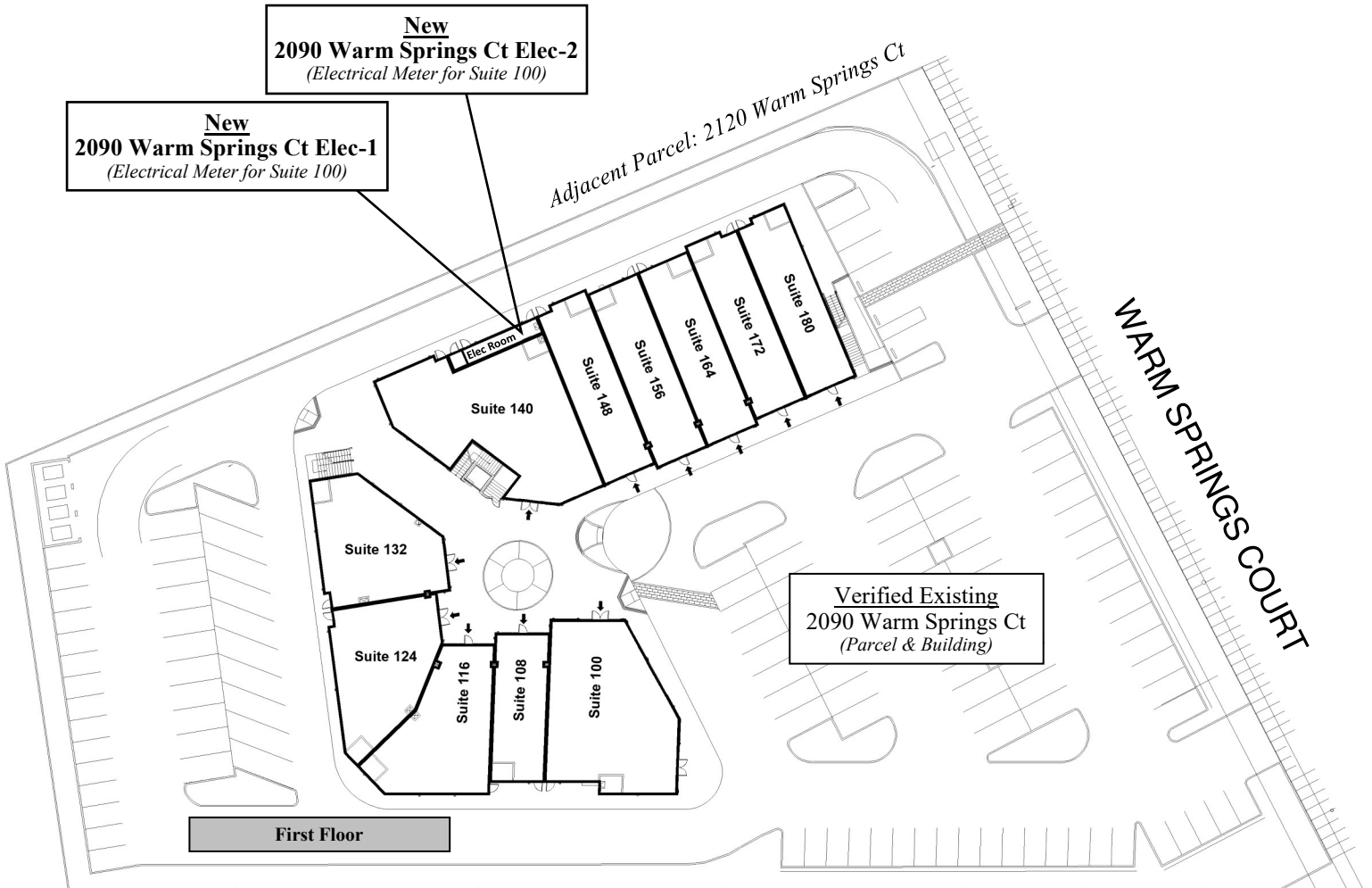

Adjacent Parcel: 2066 Warm Springs Ct

FOR ADDRESSING PURPOSES ONLY

SP78-0071

3/24/2025

(RC)