

**LOCATIONAL MAP**

**ADDRESS CHRONOLOGY**

- Initial addressing at time of original development: 1974
- Address issued for new tenant space: 6/282019 (RW)

**CONDITIONS OF APPROVAL:**

1. The addresses of the tenant spaces shall be prominently posted so that they are readily viewed and the spaces easily identified.
2. In the future when the space occupied by "39700 Mission Blvd" is vacated, a re-evaluation of the address shall be required to determine if a new address is needed which better matches the street range and address flow.

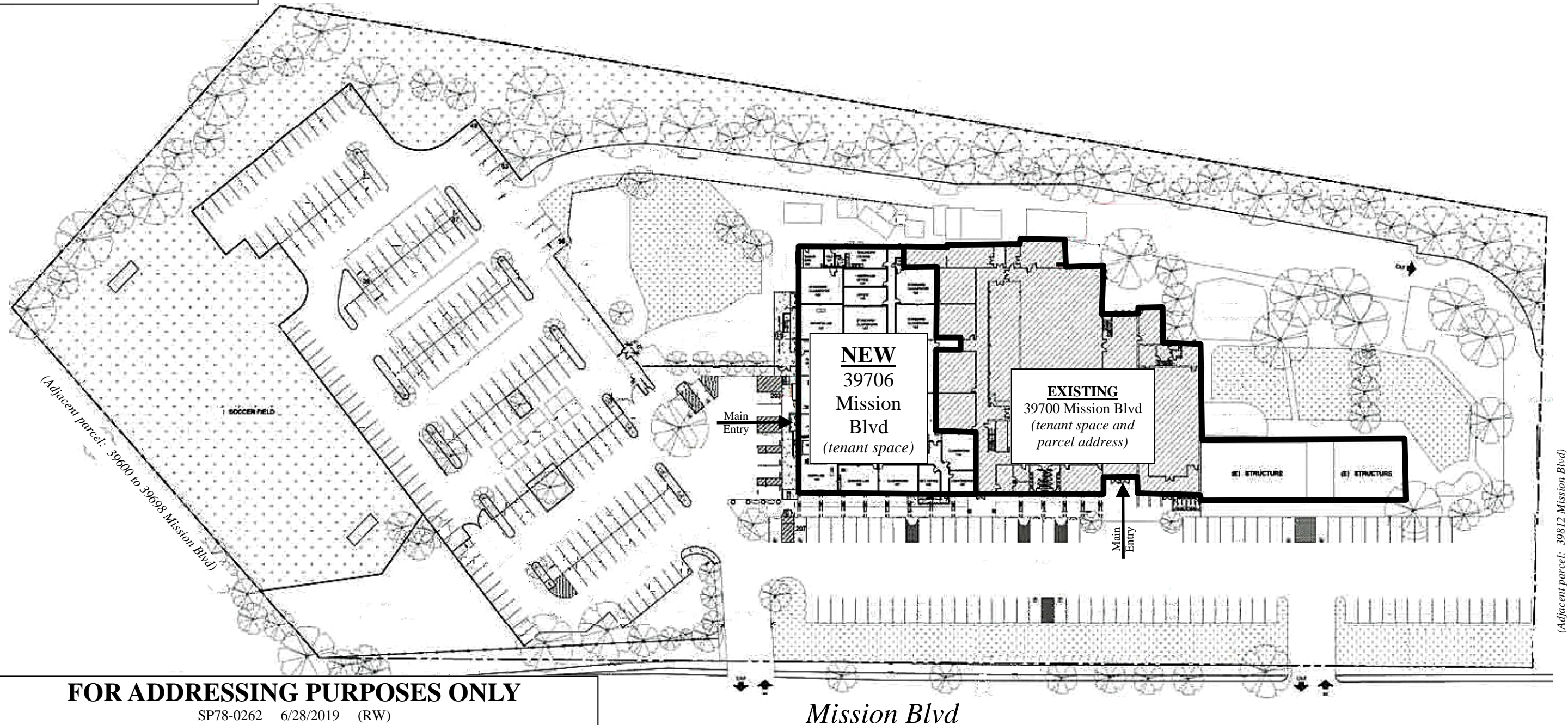

**FOR ADDRESSING PURPOSES ONLY**

SP78-0262 6/28/2019 (RW)



*Mission Blvd*

(Adjacent parcel: 39812 Mission Blvd)