



LOCATIONAL MAP

ADDRESS CHRONOLOGY

- Parcel address issued at time of initial development: 1958
- Address issued to accessory dwelling unit: 7/1/2019 (RC)

Legend
 ↗ Front Door Location

New
 42738 Jefferson Street
 (Accessory Dwelling Unit)

Existing
 42740 Jefferson Street
 (Parcel & Single Family Home)

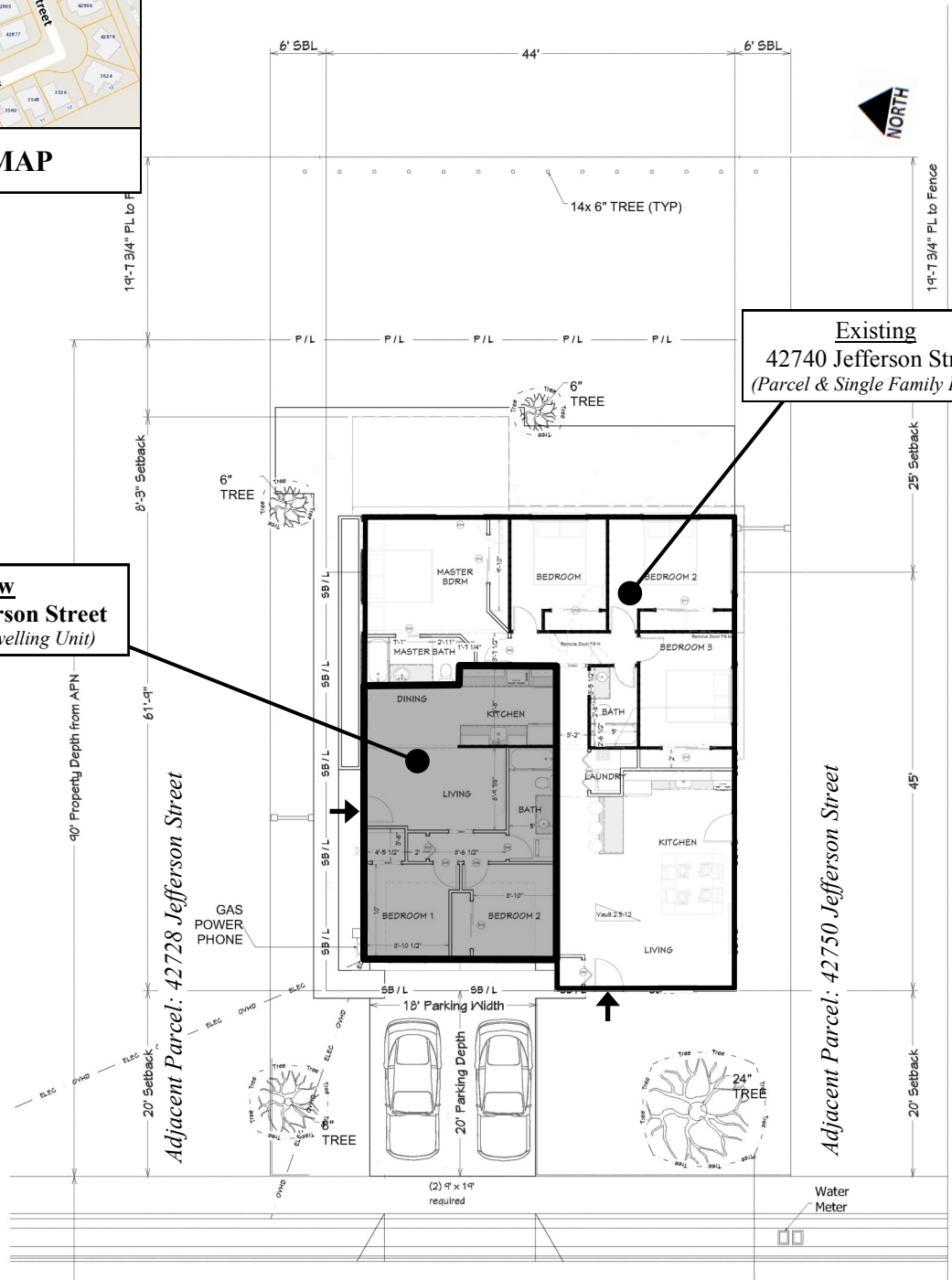

JEFFERSON STREET



FOR ADDRESSING PURPOSES ONLY

SP78-0263 7/1/2019 (RC)