

LOCATIONAL MAP

ADDRESS CHRONOLOGY

- Initial addressing at time of original (industrial) development: 1994 (RG)
- Assign 47111 Mission Falls Ct to project site; and, rescind seven existing addresses (i.e., 47005, 47025, 47055, 47075, 47105, 47135 and 47145 Mission Falls Ct) which were residual addresses from the previous industrial development and are no longer required: 5/6/2019 (RW)

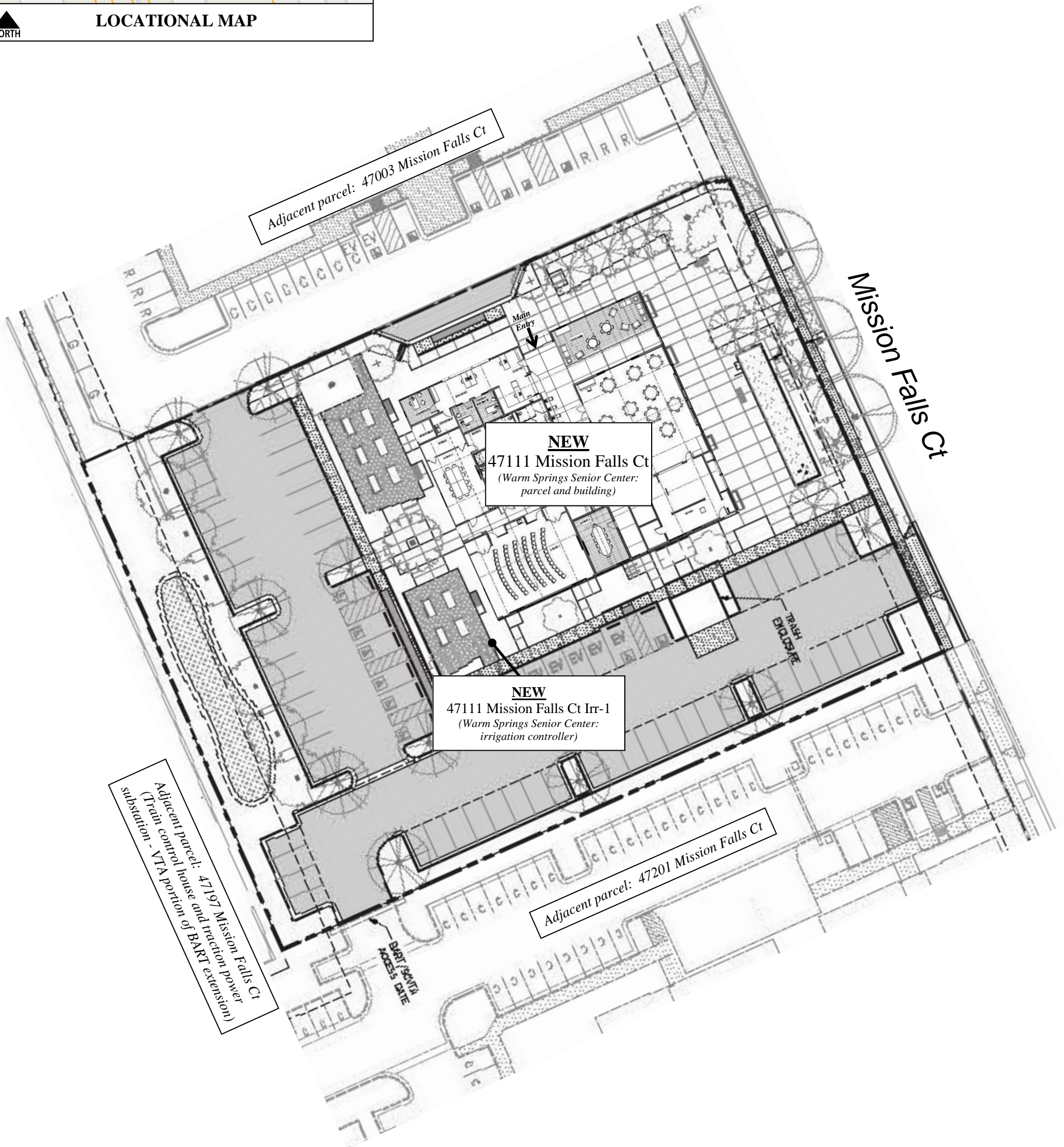

FOR ADDRESSING PURPOSES ONLY

SP84-0028 5/6/2019 (RW)