

LOCATIONAL MAP



Floor Plan

ADDRESS CHRONOLOGY

- Original addressing at time of initial development: 3/7/1985 (JC)
- Addressing action: 9/2/2014 (RW)
 1. Verification of two existing addresses (48501 and 48507 Milmont Dr)
 2. Rescind two existing addresses (48499 and 48503 Milmont Dr).

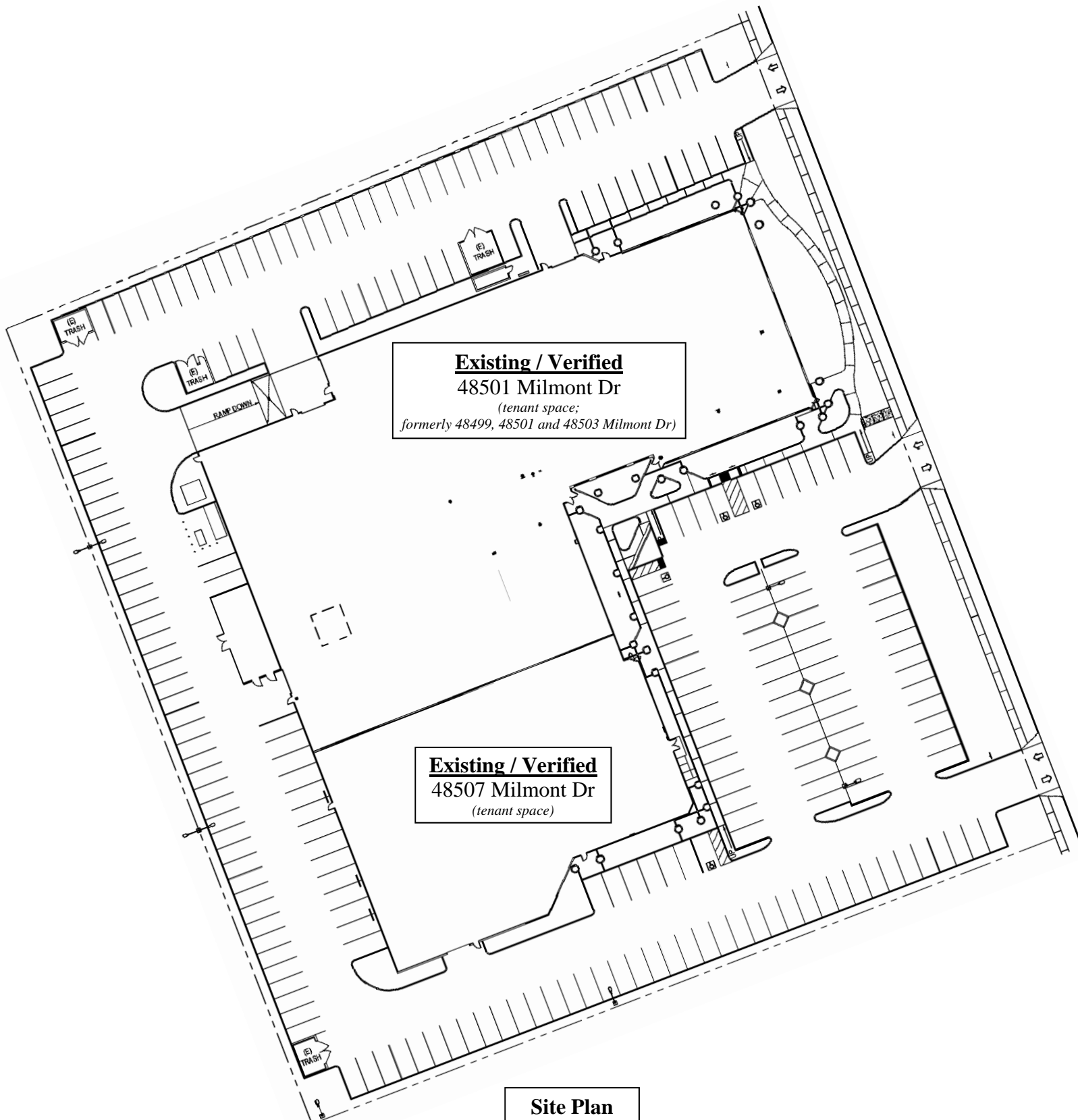

Site Plan