

- ADDRESS CHRONOLOGY**
- Addressing at time of initial construction: 9/23/1988 (HG)
 - Bldg C / 48860 Milmont Dr - suite number changes (# 105C, # 106C and # 107C): 7/24/2004 (RW)
 - Issuance of address for new tenant space at 48834 Kato Rd: 12/7/2012 (RW)

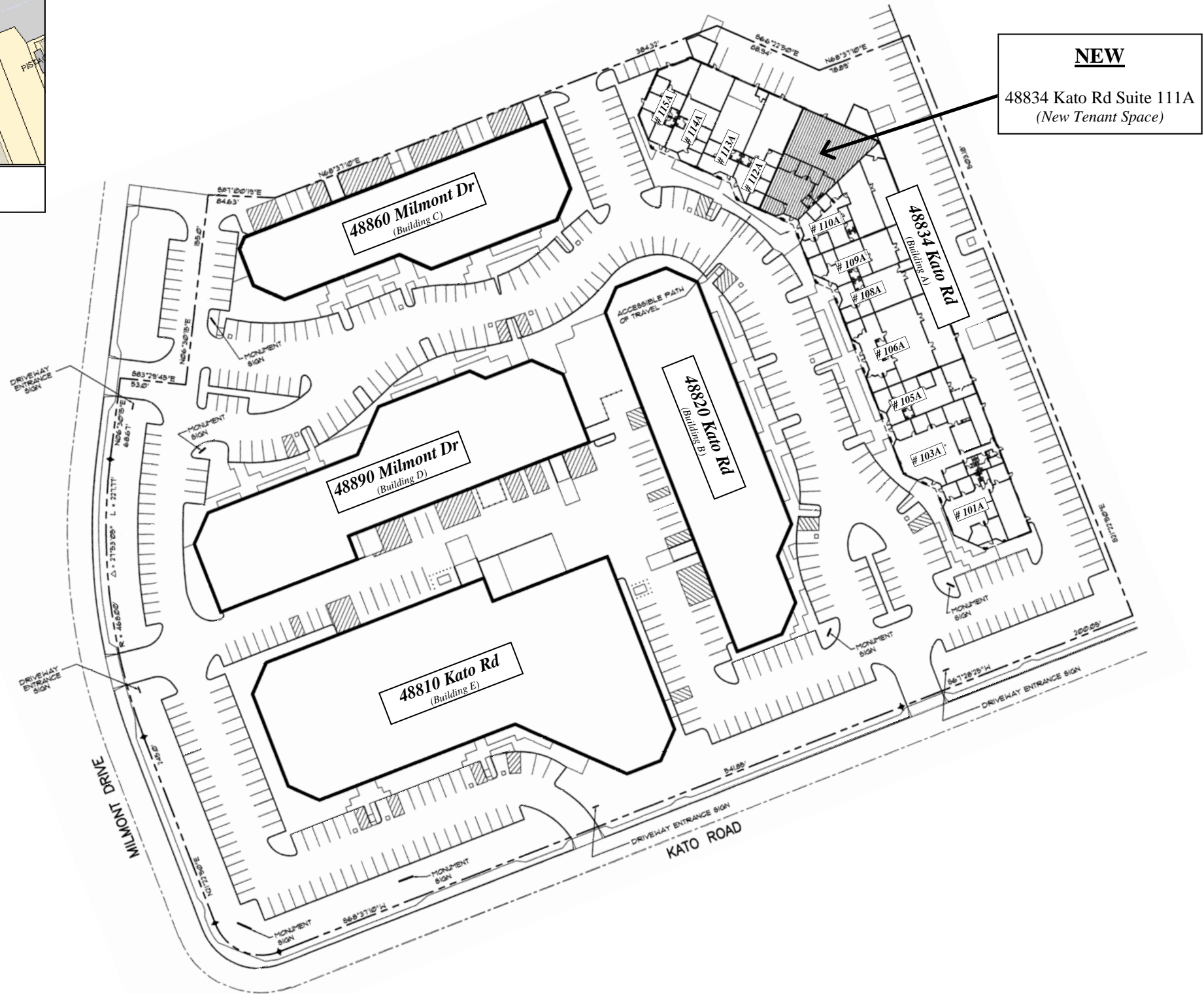

NEW
48834 Kato Rd Suite 111A
(New Tenant Space)

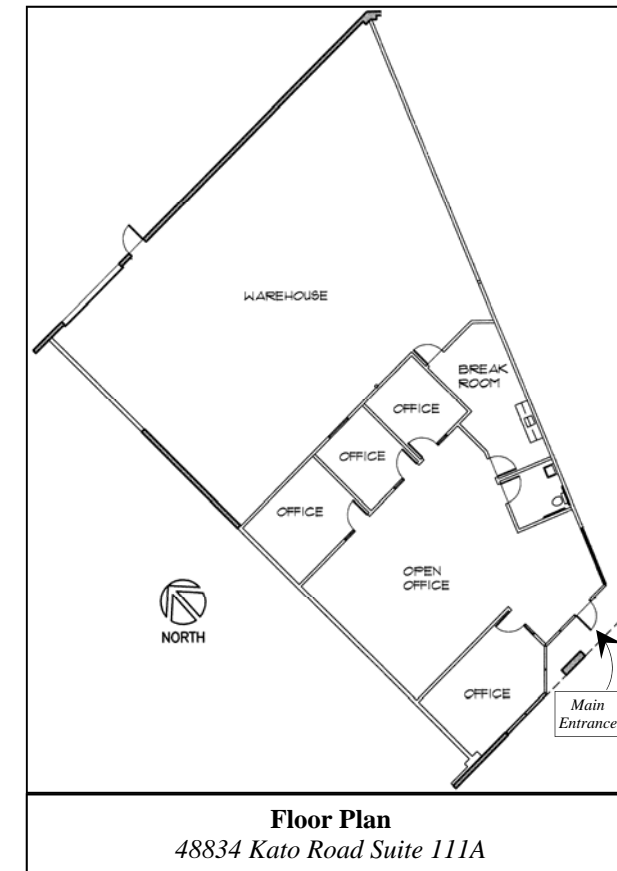

Floor Plan
48834 Kato Road Suite 111A