

LOCATIONAL MAP

ADDRESS CHRONOLOGY

- Initial addressing: date unknown
- Address verification of site location as 905 Warren Ave: 8/7/2012 (RW)
- Addressing assignment for Traffic Signal and Street Light Pedestal: 3/21/2013 (RW/RC)
- Address assigned to relocated Caltrans Pedestal for Ramp Metering: 5/16/2013 (RW)

NEW
905 Warren Ave Meter C
(Relocated CALTRANS Pedestal for Ramp Metering)

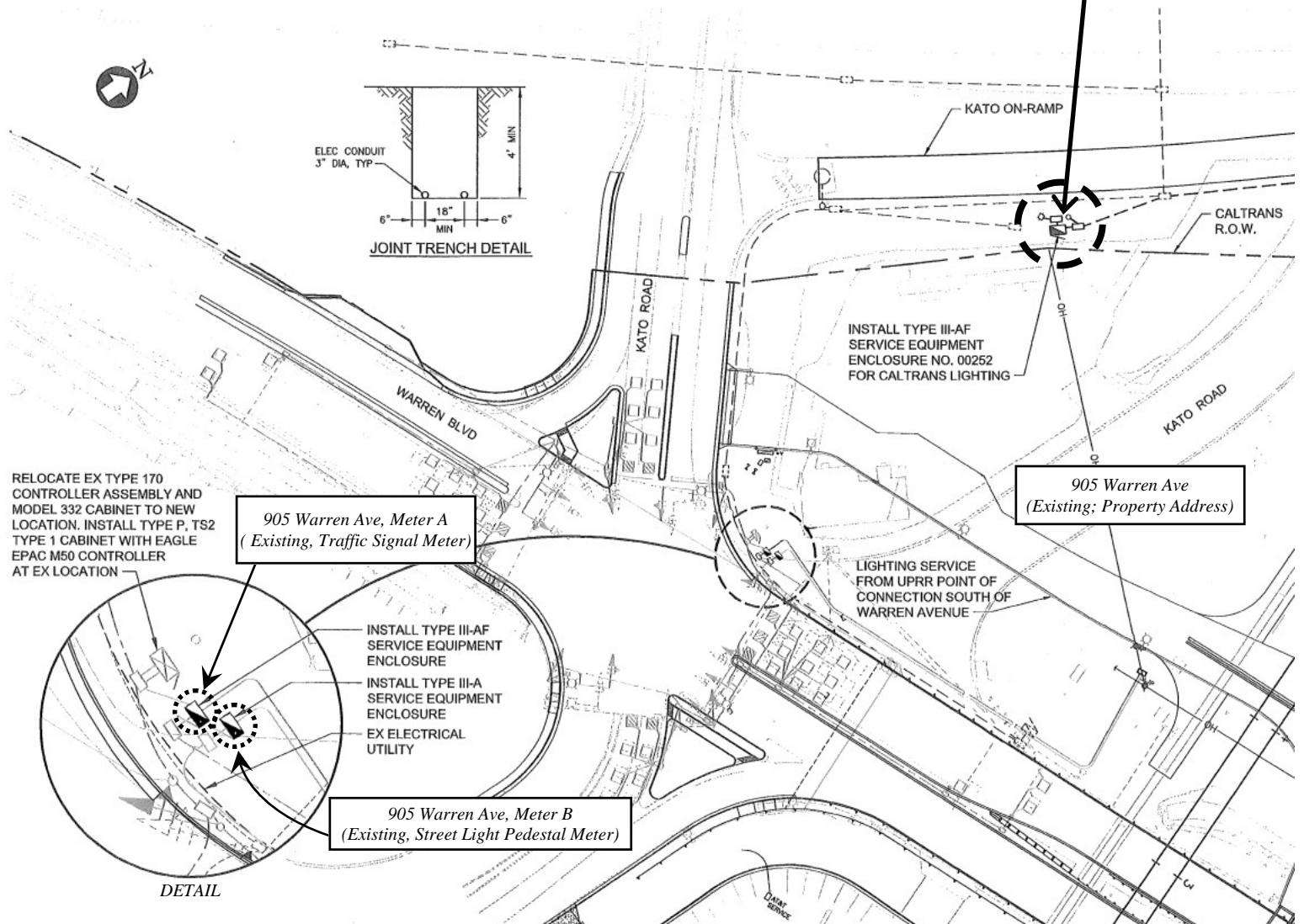

RELOCATE EX TYPE 170 CONTROLLER ASSEMBLY AND MODEL 332 CABINET TO NEW LOCATION. INSTALL TYPE P, TS2 TYPE 1 CABINET WITH EAGLE EPAC M50 CONTROLLER AT EX LOCATION

905 Warren Ave, Meter A
(Existing, Traffic Signal Meter)

INSTALL TYPE III-AF SERVICE EQUIPMENT ENCLOSURE
 INSTALL TYPE III-A SERVICE EQUIPMENT ENCLOSURE
 EX ELECTRICAL UTILITY

905 Warren Ave, Meter B
(Existing, Street Light Pedestal Meter)

DETAIL

INSTALL TYPE III-AF SERVICE EQUIPMENT ENCLOSURE NO. 00252 FOR CALTRANS LIGHTING

905 Warren Ave
(Existing; Property Address)

LIGHTING SERVICE FROM UPRR POINT OF CONNECTION SOUTH OF WARREN AVENUE

FOR ADDRESSING PURPOSES ONLY

