

**ADDRESS CHRONOLOGY**

- Initial addressing at time of original development: 1900
- Six (6) new addresses assigned, five (5) existing addresses verified, and one (1) existing address rescinded: 2/10/2017 (RW)

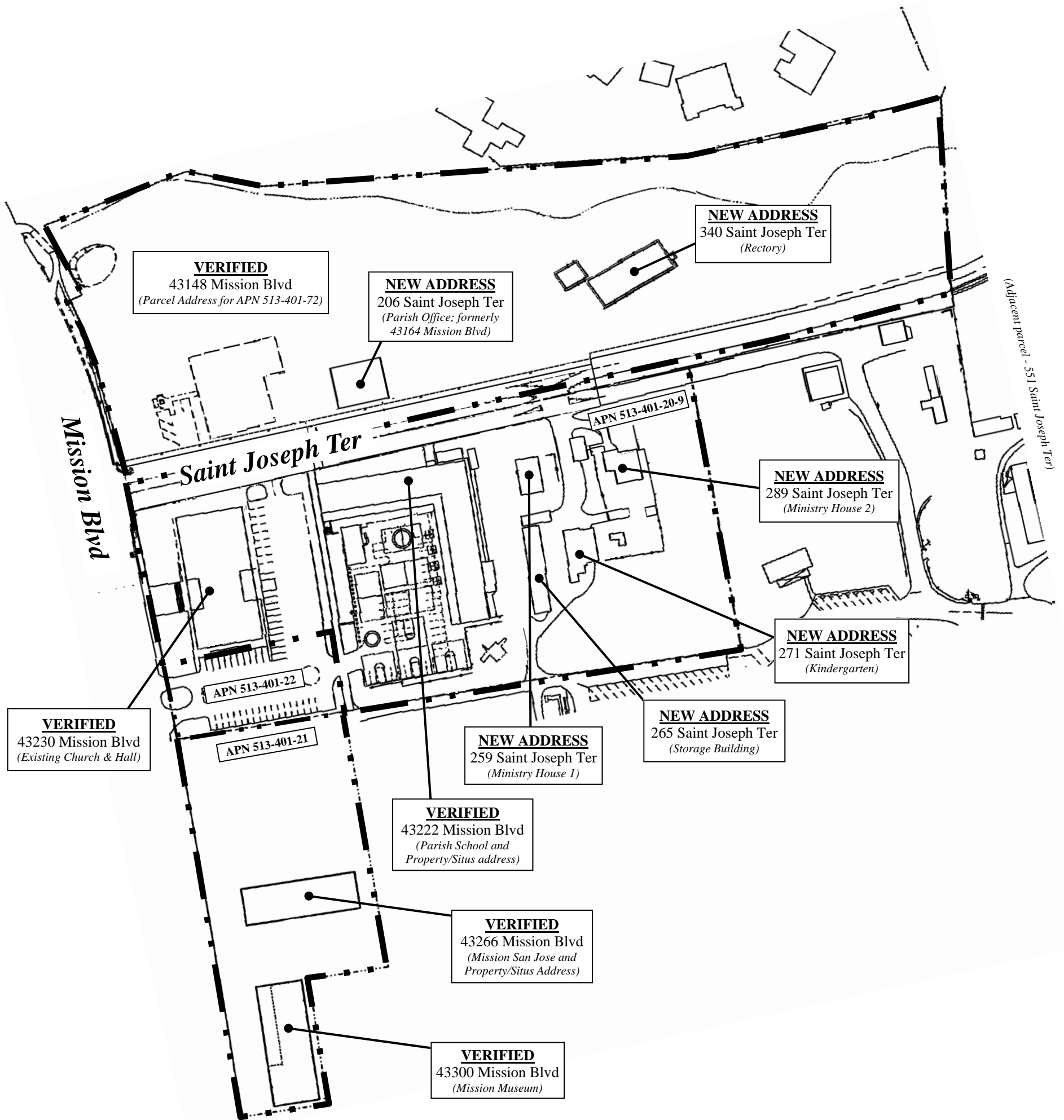

**FOR ADDRESSING PURPOSES ONLY**

SP84-0281 2/10/2017 (RW)